

Jasper County, Iowa

Denny Carpenter

Doug Cupples

Brandon Talsma



Board of Supervisors

Courthouse

PO Box 944

Newton IA 50208

Phone 641-792-7016

Fax 641-792-1053

JASPER COUNTY BOARD OF SUPERVISORS MEETING AGENDA

www.co.jasper.ia.us

October 8th 2019

Pledge of Allegiance

- Item 1 **Human Resources – Dennis Simon**
 - a) Employee Hiring Resolution – Assessor’s Clerk

- Item 2 **Information Systems – Ryan Eaton**
 - a) Update on the Courthouse Lightening Strike

- Item 3 **Engineer – Russ Stutt**
 - a) Resolution approving PCC overlay plans

- Item 4 **Auditor – Dennis Parrott**
 - a) Hiring Resolution Auditors Clerk, Leyna Noah
 - b) Hiring Resolution Auditors Clerk, Michele Ergenbright

- Item 5 **Planning & Zoning – Nick Fratzke**
 - a) Approval for the Heggen Subdivision Plat

- Item 6 **Approval of Board of Supervisors minutes for 10/01/19**

- Item 7 **Board Appointments**

PUBLIC INPUT & COMMENTS

JASPER COUNTY ENGINEER'S OFFICE
910 N 11th Ave E
Newton, Iowa 50208

(641) 792-5862
FAX – (641) 791-7740



Russell A. Stutt, P.E.
County Engineer
rstutt@co.jasper.ia.us

Pamela Olson
Assistant to the Engineer
polson@co.jasper.ia.us

Jason Lowry
County Land Surveyor
jlowry@co.jasper.ia.us

Board Agenda for October 8, 2019

- a. Resolution approving PCC overlay plans

Resolution No. _____

RESOLUTION OF FINAL PLAN SUBMITTAL FOR
PROJECT NUMBER STBG-SWAP-C050(125)—FG-50

Moved by, _____ seconded by, _____

To sign and approve Final Plans for a January 22, 2020 D.O.T Letting on project STBG-SWAP-C050(125)—FG-50, PCC overlay on a portion of F62 laying between IA 163 and IA 14 in Fairview West Township, Jasper County, Iowa.

AYES: _____

NAYS: _____

Approved this 8th day of October, 2019.

Dennis Carpenter
Chairman Board of Supervisors

Brandon Talsma
Board of Supervisors

Doug Cupples
Board of Supervisors

ATTEST: _____

Dennis Parrott
Jasper County Auditor

LEGEND

- DIVIDED HIGHWAY
- PAVED ROAD
- BITUMINOUS ROAD
- GRAVEL ROAD
- EARTH ROAD
- INTERSTATE HIGHWAY
- UNITED STATES HIGHWAY
- COUNTY HIGHWAY
- RAILROAD
- HYDROLOGY
- BRIDGE
- STATE BOUNDARY
- COUNTY BOUNDARY
- SECTION LINE
- TOWNSHIP LINE

DESIGN DATA	
2018 AADT	670 VPD
2038 AADT	1300 VPD
DESIGN SPEED	60 MPH
TRUCKS	20%

CONTACT INFORMATION
 JASPER COUNTY ENGINEER'S OFFICE
 910 N 14TH AVE E
 NEWTON, IA 50208
 PHONE: 641.792.5862
 FAX: 641.791.1740

IOWA
 DEPARTMENT OF TRANSPORTATION
 HIGHWAY DIVISION
 PLANS OF PROPOSED IMPROVEMENT ON THE
FARM TO MARKET SYSTEM
JASPER COUNTY
 STBG-SWAP-C050(125)--FG-50
PCC OVERLAY-UNBONDED
 Located on Highway F-62 from Iowa Highway 163
 easterly 4.15 miles to Iowa Highway 14

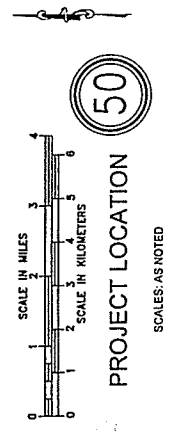
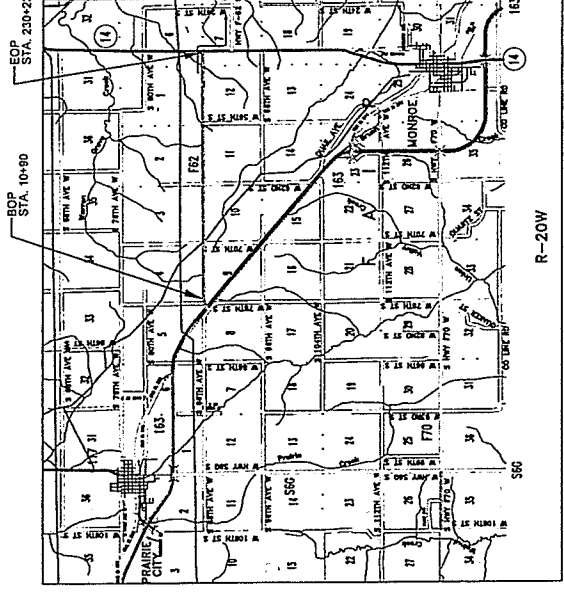

INDEX OF SHEETS

NO.	DESCRIPTION
A-01	TITLE SHEET
B-01-B-03	GENERAL NOTES AND QUANTITIES TABULATIONS
C-01-C-06	TYPICAL CROSS SECTIONS AND DETAILS
D-01-D-02	TRAFFIC CONTROL PLAN
TOTAL	12 SHEETS

MILEAGE SUMMARY

DIV.	LOCATION	LN. FT.	MILES
1	BGN. STA. 10+90 END STA. 23D+23	21993.00	4.15
	BGN. STA. 10+90 END STA. 23D+23	21993.00	4.15

STANDARD ROAD PLANS

THE FOLLOWING STANDARD PLANS SHALL BE CONSULTED APPLICABLE TO CONSTRUCTION WORK ON THIS PROJECT

STANDARD	TITLE
PR-120	STOP LINES & ISLANDS
PV-101	JOINTS
TC-202	SHOULDER CLOSURE
TC-252	ROAD CLOSURE

REFER TO THE PROPOSAL FORM FOR LIST OF APPLICABLE SPECIFICATIONS

TRAFFIC CONTROL PLAN

THIS ROAD SHALL BE CLOSED TO TRAFFIC DURING PAVING CONSTRUCTION. ROAD CLOSURE SHALL BE MAINTAINED THROUGHOUT THE CONSTRUCTION PERIOD AS SOON AS PAVEMENT REACHES MATURITY AND SHOULDER DROPELS IS LAPPED. THE CONTRACTOR SHALL FURNISH, ERECT, AND MAINTAIN DETOUR SIGNS, THE CONTRACTOR SHALL FURNISH, ERECT, AND MAINTAIN ADVANCED WARNING SIGNS, ROAD CLOSED SIGNS MOUNTED ON TYPE III BARRICADES, ROAD CLOSED TO THRU ROAD CLOSED SIGNS MOUNTED ON TYPE III BARRICADES, AND SAFETY FENCE AT SAFETY CLOSURE. SIGNS MOUNTED ON TYPE III BARRICADES SHALL BE MAINTAINED AS MAINTAINED AS PROVIDED FOR IN ARTICLE 110.02 OF THE STANDARD SPECIFICATIONS TRAFFIC CONTROL DEVICES, PROCEDURES, LAYOUTS, SIGNING, AND PAVEMENT MARKINGS INSTALLED WITHIN THE LIMITS OF THIS PROJECT SHALL CONFORM TO THE MANUAL ON UNIFORM TRAFFIC CONTROL DEVICES FOR STREETS AND HIGHWAYS AS ADOPTED BY THE DEPARTMENT PER 701 OF THE IOWA CHAPTER 130

JASPER COUNTY BOARD OF SUPERVISORS

Supervisor	Date
Supervisor	Date
Supervisor	Date

I HEREBY CERTIFY THAT THIS ENGINEERING DOCUMENT WAS PREPARED BY ME OR UNDER MY DIRECT PERSONAL SUPERVISION AND THAT I AM A duly LICENSED PROFESSIONAL ENGINEER UNDER THE LAWS OF THE STATE OF IOWA.

BY: _____ DATE: _____

RUSSELL A. STUTT, P.E. 18165
 MY LICENSE RENEWAL DATE IS DEC. 31, 2020
 SHEETS COVERED BY THIS SEAL:
 (ENTIRE SUBMISSION UNLESS SPECIFIED HERE)



THE CONTRACTOR IS REQUIRED TO OBTAIN ALL NECESSARY PERMITS FROM ALL UTILITIES FOR ALL EXISTING UTILITIES.

UTILITY CONTACT INFORMATION

UTILITY COMPANY NAME	CONTACT PERSON	PHONE	ADDRESS
(A) IZAT & T TRANSMISSION	Lenny Voits	8162754014	1802 SE Delaware Ave, Suite 114, Ankeny, IA 50021
(C) IOWA REGIONAL UTILITY ASSOC	HEATHER LOSHAW	6417927011	1351 Iowa Speedway Dr, Newton, IA 50208
(G) ILLINOIS CENTURYLINK	Tom Stummer	7205788090	135 E Main St, Marshalltown, IA 50158
(I) IOWA COMMUNICATIONS NETWORK	Shannon Malow	8005723940	Grimes Building, 400 E 14th St, Des Moines, IA 50319
(M) 95 MIDAMER-ELEC	Craig Ranfield	5152526632	2411 N Market St, Okaloosa, IA 52577
(M) 95 MIDAMER-ELEC	Craig Ranfield	5152526632	2411 N Market St, Okaloosa, IA 52577
(M) 61 MIDAMER-FIBER	Telecom On Call	5152812313	2411 N Market St, Okaloosa, IA 52577
(N) SOUTHERN NATURAL GAS COMPANY	Keith Good	5152025067	6751 Merle Hwy Rd, Johnston, IA 50131
(O) KIOCREK NORTH SYSTEM L.L.C.	WHITLEY VANAMAN	5802956516	3114 Main Ave, Clear Lake, IA 50428
(U) IOWA WINDSTREAM COMMUNICATIONS	LOCATE DESK	8002951901	3540 SW 61st St, Des Moines, IA 50321

ESTIMATED PROJECT QUANTITIES

NO.	ITEM CODE	ITEM	UNIT	QUANTITY
1	2115-0100000	MODIFIED SUBBASE	CY	234.00
2	2211-7425020	GRANULAR SHOULDER, TYPE B	TONS	11507.30
3	2215-7100400	RELOCATION OF MAIL BOX	EACH	12
4	2301-1034000	STD OR SLIP FORM PCC PAVEMENT, CLASS C, CLASS 31 DURABILITY, 9 IN.	SY	3639.22
5	2316-1910000	PORTLAND CEMENT CONCRETE OVERLAY, FURNISH ONLY	CY	13490.59
6	2316-8100500	PORTLAND CEMENT CONCRETE OVERLAY, PLACEMENT ONLY	SY	65216.67
7	2316-8100500	PAVEMENT INTERLAYER GEOTEXTILE	SY	57335.33
8	2316-8100500	REMOVAL OF PAVEMENT	SY	1318.22
9	2316-8100500	DRIVEWAY, PCC, 6	SY	69.00
10	2316-8100500	DRIVEWAY, PCC, 6	SY	69.00
11	2316-8100500	DRIVEWAY, PCC, 6	SY	69.00
12	2326-8235000	CONSTRUCTION SURVEY	EACH	8
13	2327-9251117	PAINTED PAVEMENT MARKINGS, DURABLE	LS	1
14	2327-9270111	GROOVES CUT FOR PAVEMENT MARKINGS	STA	656.50
15	2328-8445110	TRAFFIC CONTROL	STA	656.50
16	2329-5070110	PATCH, FULL-DEPTH FINISH, BY AREA	LS	1
17	2329-5070120	PATCH, FULL-DEPTH FINISH, BY COUNT	EAH	946.69
18	2333-4360005	MOBILIZATION	LS	1

GENERAL NOTES

- THE CONTRACTOR SHALL CONTAIN ALL WORK TO THE EXISTING RIGHT OF WAY UNLESS WRITTEN PERMISSION IS OBTAINED FROM PERSPECTIVE PROPERTY OWNER AND PRESENTED TO THE CONTRACTING AUTHORITY.
- ALL RUBBLE AND DEBRIS GENERATED BY REMOVAL CONSTRUCTION OPERATIONS SHALL BE CLEANED UP AND DISPOSED OF BY THE CONTRACTOR IN COMPLIANCE WITH APPLICABLE FEDERAL, STATE, AND LOCAL REQUIREMENTS.
- ANY EXISTING FIELD TILE THAT IS DISTURBED DURING CONSTRUCTION SHALL BE REPLACED OR REPAIRED TO FUNCTION AS WELL OR BETTER THAN ORIGINAL BY THE CONTRACTOR AT THEIR EXPENSE.
- IT WILL BE THE CONTRACTOR'S RESPONSIBILITY TO NOTIFY ALL UTILITIES ON THIS PROJECT PRIOR TO BEGINNING WORK, AS PER ARTICLE 1107.5 OF THE STANDARD SPECIFICATIONS.
- STANDARD SPECIFICATION SECTIONS ASSOCIATED WITH ITEM CODES SHALL APPLY UNLESS OTHERWISE NOTED.
- 911 SIGNS SHALL NOT BE DISTURBED UNLESS THEY INTERFERE WITH CONSTRUCTION. DISTURBED 911 SIGNS SHALL BE REPLACED BY OTHERS.
- A PLAN FOR STAGE CONSTRUCTION OF LOCAL ACCESSES WHICH ARE REQUIRED TO REMAIN OPEN TO TRAFFIC DURING CONSTRUCTION SHALL BE SUBMITTED BY THE CONTRACTOR FOR APPROVAL BY THE ENGINEER PRIOR TO CONSTRUCTION.
- CONTRACTOR SHALL NOTIFY COUNTY 3 WEEKS PRIOR TO STARTING CONSTRUCTION. CONTRACTOR SHALL TAKE CARE NOT TO DISTURB OR DESTROY CONTROL POINTS SET ON THE PROJECT.

ESTIMATE REFERENCE INFORMATION

NO.	BID ITEM NOTES
2	SHOULDER QUANTITY CALCULATED AT 150W.C.F. GRADATION #11 FOR CLASS A STONE SHALL APPLY. AGGREGATE SHALL CONTAIN SURFICIAL MOISTURE TO OBTAIN COMPACTION. SHOULDER MATERIAL SHALL BE PLACED IN TWO LIFTS. RUBBER TIRE ROLLER SHALL BE USED FOR FIRST LIFT. SMOOTH DRUM ROLLER SHALL BE USED FOR FINAL COMPACTION. QUANTITY INCLUDES MATERIAL FOR 14 SPACINGS. SEE TABULATION JAS-17 ON SHEET B.02 FOR QUANTITIES AND 6 SIDE ROAD/SEE INTERSECTION DETAIL SHEETS FOR QUANTITIES. MATERIAL MUST BE FROM AN DOT CERTIFIED SOURCE. THE CONTRACTOR SHALL COORDINATE PAVING AND SHOULDERING OPERATIONS. A MAXIMUM OF 3 MILES OF MATURED MAINLINE PAVEMENT WILL BE ALLOWED WITHOUT PLACING GRANULAR SHOULDERS.
3	CONTRACTOR TO REMOVE AND RESET, ACCORDING TO U.S. POSTAL REQUIREMENTS, ANY MAILBOXES AS NECESSARY. TEMPORARY MEASUREMENT OF MAILBOXES DURING STAGED CONSTRUCTION SHALL BE COORDINATED WITH THE POST OFFICE. ITEM SHALL BE MEASURED PER EACH MAILBOX REMOVED AND REPLACED AND PAID FOR EACH AT THE CONTRACT UNIT PRICE. MULTIPLE MAILBOXES WITH SAME POST COUNT AS ONE MAILBOX. MAILBOXES WITH MULTIPLE POSTS COUNT AS ONE MAILBOX. SEE TABULATION JAS-30 ON SHEET B.02.
4	CLASS C MIX WITH CLASS 31 DURABILITY SHALL BE USED. STRENGTH OF PCC USING MATURITY METHOD SHALL APPLY. MATURITY CURVE SHALL BE ESTABLISHED BEFORE START OF PAVING. CERTIFIED PLANT INSPECTION SPECIFICATION SHALL APPLY. PAVEMENT SMOOTHNESS SPECIFICATION 2316 SHALL APPLY. THERE WILL BE NO GRINDING OF NEW PCC UNLESS APPROVED BY PROJECT ENGINEER. L-1 JOINT SHALL BE PLACED AT CENTERLINE. SKEWED TRANSVERSE "C" JOINTS SHALL BE AS PER STANDARD PV-101 AT 12 SPACINGS. PERPENDICULAR TRANSVERSE JOINTS WILL BE ALLOWED AT INTERSECTIONS AS SHOWN OR AS APPROVED BY THE ENGINEER.
5 & 6	CONCRETE SHALL BE CLASS C MIX WITH CLASS 31 DURABILITY. FURNISH ONLY QUANTITY FIGURED AT 7" WITH 7% OVERRUN FOR OVERLAY WITH 530.96 CY. CURVE OR RADIUS THICKNESS TO EDGE OF SLAB. PLACE ONLY QUANTITY FIGURED WITH A 5% OVERRUN. MIX DESIGN SHALL BE SUBMITTED TO PROJECT ENGINEER FOR APPROVAL BEFORE START OF CONSTRUCTION. STRENGTH OF PCC BEING USED AT CENTERLINE ON MAINLINE & SIDEROADS. SKEWED TRANSVERSE JOINTS WILL BE PLACED AS PER ROAD STANDARD PV-101 AT 12 SPACINGS. PERPENDICULAR TRANSVERSE JOINTS WILL BE PLACED AS PER ROAD STANDARD PV-101 AT 12 SPACINGS. PERPENDICULAR TRANSVERSE JOINTS WILL BE PLACED AS PER ROAD STANDARD PV-101 AT 12 SPACINGS. PERPENDICULAR TRANSVERSE JOINTS WILL BE PLACED AS PER ROAD STANDARD PV-101 AT 12 SPACINGS. THERE WILL BE NO GRINDING OF NEW PCC UNLESS APPROVED BY PROJECT ENGINEER. CERTIFIED PLANT INSPECTION SPECIFICATION 2316 SHALL APPLY. CONTRACTOR SHALL BLADE AND SHAPE SHOULDERS PRIOR TO OVERLAY TO ALLOW FOR 2" WIDENING. SEE PROPOSED CROSS SECTION ON SHEET C.01 FOR DETAILS. EXCESS SHOULDER MATERIAL SHALL BE PLACED ON FORESLOPE. BLADING AND SHAPING OF SHOULDERS IS INCIDENTAL TO THIS ITEM.
7	CONTRACTOR SHALL USE 16 OZ./SY FABRIC. REFER TO DS-15692.
8	SEE TABULATION JAS-17 ON SHEET B.02 FOR LOCATIONS. CONTRACTOR SHALL BE RESPONSIBLE FOR REMOVING AND DISPOSING OF EXISTING PAVEMENT ACCORDING TO SECTION 1104.08 OF THE STANDARD SPECIFICATIONS. SAW CUTS FOR REMOVAL SHALL BE CONSIDERED INCIDENTAL. EXISTING PAVEMENT THICKNESS IS ESTIMATED TO BE 7", BUT MAY VARY.
9	SEE TABULATION JAS-17 ON SHEET B.02 FOR LOCATIONS AND QUANTITIES. SEE SHEETS C.09-C.10 FOR JOINT DETAILS.
10	SEE TABULATION JAS-17 ON SHEET B.02 FOR LOCATIONS. CONTRACTOR SHALL BE RESPONSIBLE FOR REMOVING AND DISPOSING OF EXISTING PAVEMENT ACCORDING TO SECTION 1104.08 OF THE STANDARD SPECIFICATIONS. SAW CUTS FOR REMOVAL SHALL BE CONSIDERED INCIDENTAL.
11	SEE TABULATION JAS-10 ON SHEET B.02 FOR LOCATIONS. ROAD SAFETY CLOSURES SHALL BE FURNISHED & PLACED BY CONTRACTOR AT BOTH ENDS OF PROJECT & SIDEROADS, AS PER ROAD STANDARD TC-262. CONTRACTOR SHALL BE RESPONSIBLE FOR MAINTAINING ROAD SAFETY CLOSURES.
12	STRINGLESS PAVING IS ENCOURAGED BUT NOT REQUIRED. JASPER COUNTY WILL CREATE A MODEL OF THE EXISTING PROFILE AND PROPOSED PAVEMENT SURFACE FOR STRINGLESS PAVING. JASPER COUNTY WILL PROVIDE CONTROL POINTS/BENCHMARKS TO BE USED FOR PRESERVATION OF EXISTING SECTION CORNERS AND QUARTER CORNERS. ITEM SHALL INCLUDE STAKING PAVEMENT (INCLUDING INTERSECTIONS) NOT COMPLETED BY STRINGLESS PAVING.
13	ITEM CONSISTS OF YELLOW AND WHITE PAVEMENT MARKINGS. SEE SHEET D.02 FOR DETAILS. DOUBLE CENTERLINE MARKINGS SHALL BE SPACED AT 8'. CONTRACTOR SHALL FURNISH MATERIAL CERTIFICATIONS TO PROJECT ENGINEER BEFORE PLACING PAVEMENT MARKINGS. STOP LINES SHALL BE PLACED AT B.O.P. AND E.O.P. AS PER ROAD STANDARD PM-120.
15	SEE TRAFFIC CONTROL PLAN ON SHEET D.01 FOR DETAILS. CONSTRUCTION SHALL BE STAGED SO THAT RESIDENTS ALONG THE PROJECT ROUTE WILL HAVE ACCESS TO THEIR HOMES AND DRIVEWAYS DAILY (SEE TABLE JAS-17 FOR DRIVEWAY LOCATIONS). IN LIEU OF STAGING THE CONTRACTOR MAY PROVIDE LOCAL ACCESS (E.G. GOLF CARTS OR ATVs) TO ENSURE ACCESS PRIOR TO OPENING THE PAVEMENT TO LOCAL TRAFFIC. NO EXTRA PAYMENT WILL BE MADE IF THE ALTERNATIVE IS SELECTED.
16 & 17	THIS ITEM SHALL INCLUDE PCC PATCHES AS SHOWN IN TABULATION 102-6C ON SHEET B.03. PATCHES SHALL BE PLACED USING M-4 MIX. LOCATIONS WILL BE MARKED BY JASPER COUNTY AT THE TIME OF CONSTRUCTION.

JASPER COUNTY ENGINEERING DEPARTMENT DESIGN FOR	
PCC OVERLAY - UNBONDED	
GENERAL NOTES AND QUANTITIES TABULATIONS	
DATE: JL 7-22-19	DATE: JL 9-12-19
PROJECT: STBG-SWAP-C050(125)-FG-50	

STBG-SWAP-C050(125)-FG-50

JASPER COUNTY

PCC OVERLAY-UNBONDED

SHEET B.01

TABULATION OF FULL-DEPTH PATCHES

JAS-31
8-19-19

* Not a Bid Item

Count	Location		Dimension			PCC Patches			BT Joints (No.)	CT Joints (No.)	EF Joints (No.)	Remarks
	Station	Lane (L,R or B)	Length (Feet)	Width (Feet)	Patch Thickness (Inches)	With Dowels (Sq. Yds.)	Without Dowels (Sq. Yds.)	C R C (Sq. Yds.)				
2	13+56	B	4	22	8	9.78	9.78		2	1		
2	18+27	B	3	22	8	7.33	7.33		2	1		
2	18+65	B	3	22	8	7.33	7.33		2	1		
2	19+05	B	4	22	8	9.78	9.78		2	1		
2	19+44	B	4	22	8	9.78	9.78		2	1		
1	19+82	L	3	11	8	3.67	3.67		3	3		
1	20+39	L	3	11	8	3.67	3.67		3	3		
1	20+87	L	5	11	8	11.11	11.11		3	3		
1	21+39	L	4	11	8	4.89	4.89		3	3		
1	22+55	L	4	11	8	4.89	4.89		3	3		
1	29+10	R	5	11	8	11.11	11.11		3	3		
2	32+13	B	4	22	8	9.78	9.78		2	1		
2	35+69	B	4	22	8	9.78	9.78		2	1		
2	38+08	B	4	22	8	9.78	9.78		2	1		
1	38+47	B	3	11	8	7.33	7.33		3	3		
1	38+00	L	3	11	8	3.67	3.67		3	3		
1	38+39	R	3	11	8	7.33	7.33		3	3		
2	39+53	R	3	11	8	7.33	7.33		3	3		
1	41+44	L	4	11	8	4.89	4.89		3	3		
1	42+24	R	3	11	8	3.67	3.67		3	3		
1	45+80	L	22	11	8	26.89	26.89		2	1		
1	45+88	R	4	11	8	4.89	4.89		3	3		
2	47+12	B	4	22	8	9.78	9.78		2	1		
1	47+58	L	4	11	8	4.89	4.89		3	3		
2	49+14	B	4	22	8	9.78	9.78		2	1		
2	50+25	B	5	22	8	12.22	12.22		2	1		
1	53+11	L	4	11	8	4.89	4.89		3	3		
1	54+26	R	4	11	8	4.89	4.89		3	3		
2	55+62	B	5	22	8	12.22	12.22		2	1		
2	55+68	B	5	22	8	12.22	12.22		2	1		
2	58+20	B	5	22	8	12.22	12.22		2	1		
2	59+40	B	17	11	8	30.78	30.78		2	1		
2	71+40	B	3	11	8	7.33	7.33		3	3		
2	74+45	B	3	11	8	7.33	7.33		3	3		
2	75+26	B	4	22	8	9.78	9.78		2	1		
1	81+20	L	15	11	8	18.33	18.33		2	1		
1	85+60	R	4	11	8	4.89	4.89		3	3		
1	89+07	R	4	11	8	4.89	4.89		3	3		
2	89+87	R	5	22	8	12.22	12.22		2	1		
1	90+63	L	4	11	8	4.89	4.89		3	3		
1	93+36	R	5	11	8	6.11	6.11		3	3		
1	105+50	L	7	11	8	8.56	8.56		3	3		
1	105+50	R	3	11	8	3.67	3.67		3	3		
2	108+30	B	4	22	8	9.78	9.78		2	1		
1	120+87	L	15	11	8	18.33	18.33		2	1		
1	124+55	B	3	22	8	7.33	7.33		3	3		
1	152+97	L	4	11	8	4.89	4.89		3	3		
2	153+37	B	3	22	8	7.33	7.33		3	3		
2	180+58	B	4	22	8	9.78	9.78		2	1		
2	181+33	B	3	22	8	7.33	7.33		3	3		
2	181+72	B	4	22	8	9.78	9.78		2	1		
2	182+51	B	5	22	8	12.22	12.22		2	1		
1	183+28	R	4	11	8	4.89	4.89		3	3		
1	185+28	R	4	11	8	4.89	4.89		3	3		
1	186+45	L	4	11	8	4.89	4.89		3	3		
1	189+25	R	6	11	8	7.33	7.33		3	3		
1	172+42	L	4	11	8	4.89	4.89		3	3		
1	181+48	R	6	11	8	7.33	7.33		3	3		
2	182+20	B	4	22	8	9.78	9.78		2	1		
2	182+30	B	4	22	8	9.78	9.78		2	1		
1	182+70	R	4	11	8	4.89	4.89		3	3		
2	183+51	B	3	22	8	7.33	7.33		3	3		
2	184+48	B	4	22	8	9.78	9.78		2	1		
1	188+42	L	3	11	8	3.67	3.67		3	3		
2	192+50	B	5	22	8	12.22	12.22		2	1		

PCC OVERLAY-UNBONDED

JASPER COUNTY

STBG-SWAP-C050(125)--FG-50

SHEET B.03

TABULATION OF FULL-DEPTH PATCHES

JAS-31
8-19-19

* Not a Bid Item

Count	Location		Dimension			PCC Patches			BT Joints (No.)	CT Joints (No.)	EF Joints (No.)	Remarks
	Station	Lane (L,R or B)	Length (Feet)	Width (Feet)	Patch Thickness (Inches)	With Dowels (Sq. Yds.)	Without Dowels (Sq. Yds.)	C R C (Sq. Yds.)				
1	184+50	L	6	11	8	7.33	7.33		3	3		
2	192+73	B	3	22	8	7.33	7.33		2	1		
2	195+73	B	4	22	8	9.78	9.78		2	1		
2	198+16	B	4	22	8	9.78	9.78		2	1		
2	198+18	B	4	22	8	9.78	9.78		2	1		
2	198+97	B	5	22	8	12.22	12.22		2	1		
1	199+37	R	4	11	8	4.89	4.89		3	3		
2	199+75	B	5	22	8	12.22	12.22		2	1		
1	200+06	L	15	11	8	18.33	18.33		3	3		
1	204+15	R	4	11	8	7.33	7.33		3	3		
2	204+91	R	4	11	8	4.89	4.89		3	3		
2	205+29	R	5	22	8	12.22	12.22		2	1		
2	205+68	B	3	22	8	7.33	7.33		3	3		
2	206+06	R	4	11	8	4.89	4.89		3	3		
2	214+72	B	4	22	8	9.78	9.78		2	1		
1	219+85	L	6	11	8	7.33	7.33		3	3		
2	220+76	B	3	22	8	7.33	7.33		3	3		
1	221+12	R	5	11	8	6.11	6.11		3	3		
2	221+30	B	8	22	8	18.56	18.56		2	1		
2	221+94	B	8	22	8	18.56	18.56		2	1		
2	222+15	B	6	22	8	14.67	14.67		2	1		
2	222+32	B	8	22	8	18.56	18.56		2	1		
1	222+69	L	3	11	8	3.67	3.67		3	3		
2	223+08	B	4	22	8	9.78	9.78		2	1		
2	223+82	B	4	22	8	9.78	9.78		2	1		
2	224+55	B	4	22	8	9.78	9.78		2	1		
2	224+95	B	4	22	8	9.78	9.78		2	1		
2	225+31	B	6	22	8	14.67	14.67		2	1		
2	225+44	B	3	22	8	7.33	7.33		3	3		
2	225+87	B	5	22	8	12.22	12.22		2	1		
1	225+88	L	3	11	8	3.67	3.67		3	3		
2	228+04	B	5	22	8	12.22	12.22		2	1		
2	228+43	B	3	22	8	7.33	7.33		3	3		
2	228+81	B	3	22	8	7.33	7.33		3	3		
2	227+19	B	3	22	8	7.33	7.33		3	3		
2	282+49	B	4	22	8	9.78	9.78		2	1		

JASPER COUNTY ENGINEERING DEPARTMENT
DESIGN FOR

PCC OVERLAY - UNBONDED
GENERAL NOTES AND
QUANTITIES TABULATIONS

PROJECT NO. STBG-SWAP-C050(125)--FG-50
DATE: JUL 7-26-19
DRAWN BY: JL 9-12-19

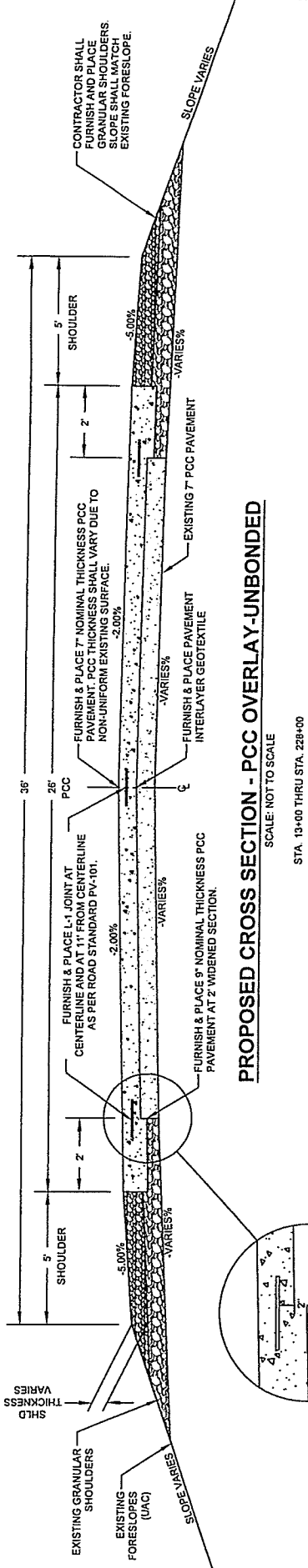

PROPOSED CROSS SECTION - PCC OVERLAY-UNBONDED

SCALE: NOT TO SCALE
 STA. 13+00 THRU STA. 228+00

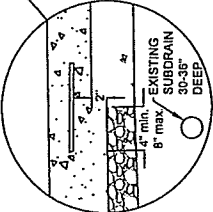

PAVEMENT INTERLAYER
 GEOTEXTILE PLACEMENT DETAIL

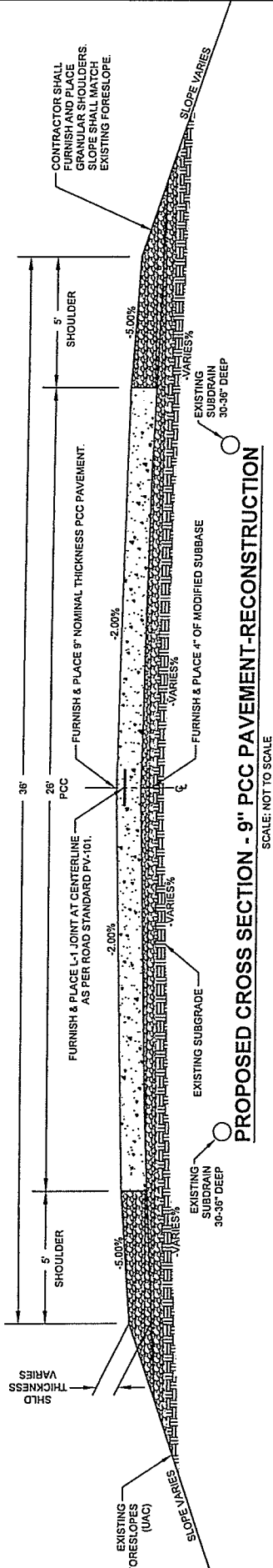

PROPOSED CROSS SECTION - 9' PCC PAVEMENT-RECONSTRUCTION

SCALE: NOT TO SCALE
 STA. 10+90 (B.O.P.) THRU STA. 13+00
 STA. 228+00 THRU STA. 230+23(E.O.P.)

JASPER COUNTY ENGINEERING DEPARTMENT	
DESIGN FOR	
PCC OVERLAY - UNBONDED	
TYPICAL CROSS SECTIONS AND DETAILS	
DATE: J.L. 06-14-19	DATE: J.L. 06-14-19
PROJECT: STBG-SWAP-C050(125)-FG-50	

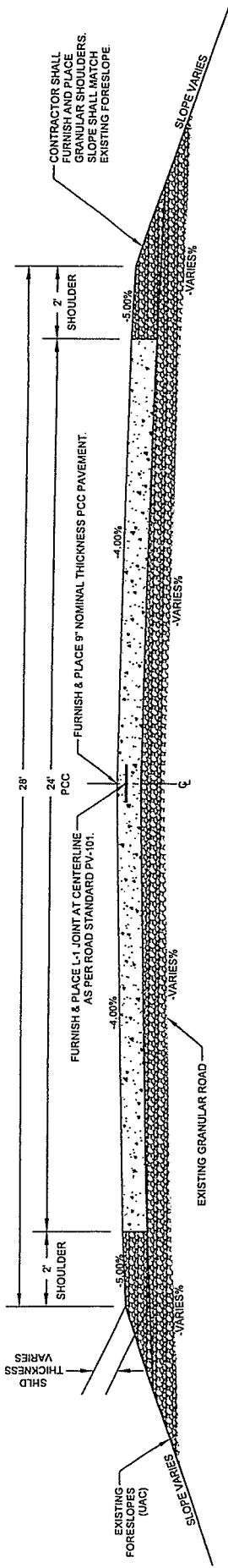

PROPOSED CROSS SECTION - 9" PCC PAVEMENT

SCALE: NOT TO SCALE
 FOR RUN-OUTS AT GRANULAR SIDE ROADS
 SEE SHEETS C.03-C.08 FOR LOCATIONS

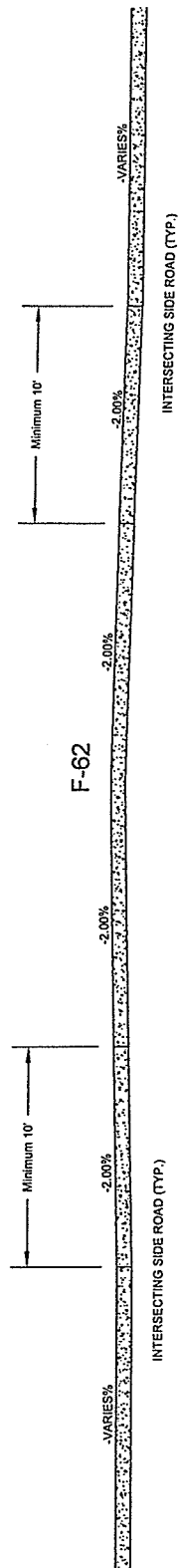

SIDE ROAD INTERSECTION DETAIL

SCALE: NOT TO SCALE
 FOR RUN-OUTS AT SIDE ROADS
 SEE SHEETS C.03-C.08 FOR LOCATIONS

JASPER COUNTY ENGINEERING DEPARTMENT	
DESIGN FOR	
PCC OVERLAY - UNBONDED	
TYPICAL CROSS SECTIONS AND DETAILS	
DATE: JL 06-14-19	DATE: JL 06-14-19
PROJECT: STBG-SWAP-C050(125)-FG-50	

W 78TH ST S INTERSECTION DETAIL

W 78TH ST S
(EXISTING ROCK)

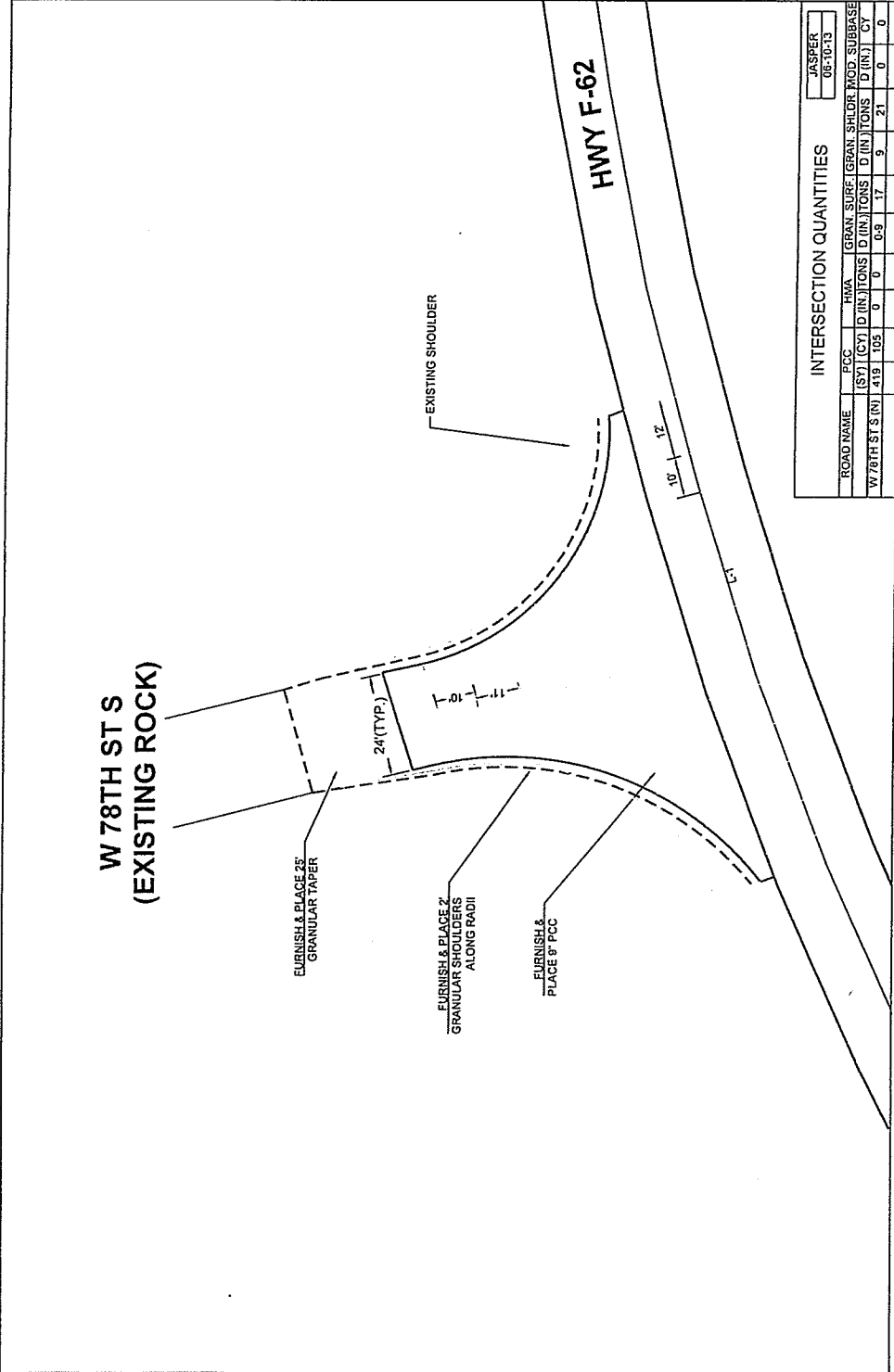

NOTES:

1. LONGITUDINAL JOINTS SHALL BE "L" OR "KT-1". TRANSVERSE JOINTS SHALL BE TYPE "C" JOINTS UNLESS OTHERWISE NOTED
2. THE ENGINEER SHALL REVIEW AND APPROVE ANY CHANGES TO THE SHOWN JOINT DETAIL PRIOR TO CONSTRUCTION
3. MAXIMUM JOINT SPACING SHALL BE 12 FEET. MINIMUM JOINT SPACING SHALL BE 2 FEET UNLESS APPROVED BY ENGINEER



(IN FEET)
1 inch = 30 ft.

INTERSECTION QUANTITIES						JASPER
ROAD NAME	PCC	HMA	GRAN. SURF.	SHLD. MOD.	SUBBASE	DATE
W 78TH ST S (N)	(CY)	D (IN)	(CY)	D (IN)	(CY)	(MM)
W 78TH ST S (N)	419	105	0	0	0	0
			0-3	17	9	21
						0
						0

JASPER COUNTY ENGINEERING DEPARTMENT
DESIGN FOR
PCC OVERLAY
TYPICAL CROSS SECTIONS AND DETAILS
DATE: JL. 06-14-19
DATE: JL. 06-14-19
PROJECT: STBG-SWAP-C050(125)--FG-50

W 56TH ST S INTERSECTION DETAIL

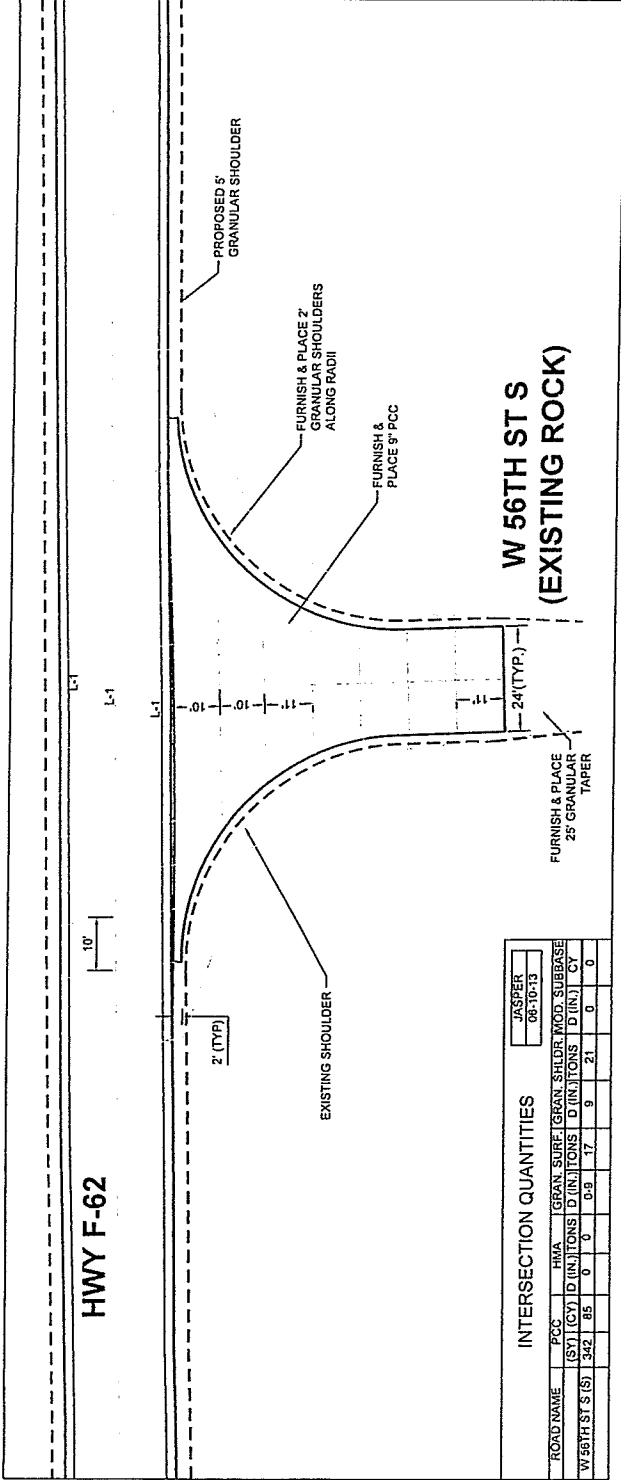

INTERSECTION QUANTITIES		JASPER	
ROAD NAME	PCC (SY) (CY)	GRAN. SUBE. (D (IN.) TONS)	MOD. SUBBASE (D (IN.) TONS)
W 56TH ST S (S)	342	85	0
	0	0	17
	0	0	21
	0	0	0

CONCRETE DRIVEWAY JOINT DETAILS

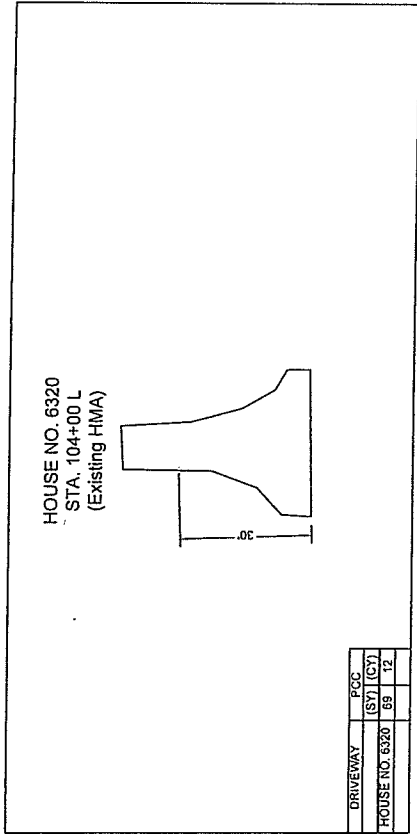

DRIVEWAY	PCC (SY) (CY)
HOUSE NO. 6320	69
	12

NOTES

1. LONGITUDINAL JOINTS SHALL BE "L-1" OR "L-1" TRANSVERSE JOINTS SHALL BE TYPE "C" JOINTS UNLESS OTHERWISE NOTED
2. THE ENGINEER SHALL REVIEW AND APPROVE ANY CHANGES TO THE SHOWN JOINT DETAIL PRIOR TO CONSTRUCTION
3. MAXIMUM JOINT SPACING SHALL BE 12 FEET. MINIMUM JOINT SPACING SHALL BE 2 FEET UNLESS APPROVED BY ENGINEER

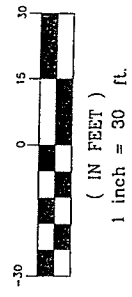

JASPER COUNTY ENGINEERING DEPARTMENT	
DESIGN FOR	
PCC OVERLAY	
TYPICAL CROSS SECTIONS AND DETAILS	
DATE PLOTTED	JL 07-03-19
PROJECT NO.	STBG-SWAP-C050(125)--FG-50

STANDARD TYPES OF PAVEMENT MARKINGS

SCALE: NOT TO SCALE

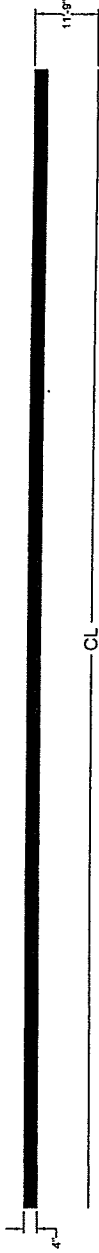

EDGE LINE
WHITE

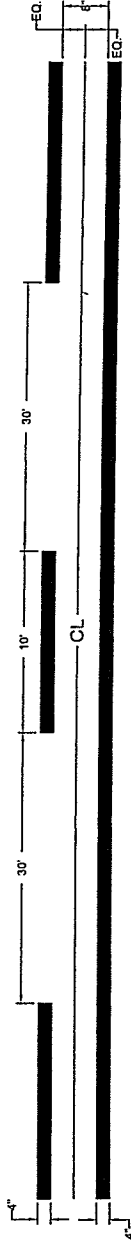

SINGLE NO-PASSING
YELLOW

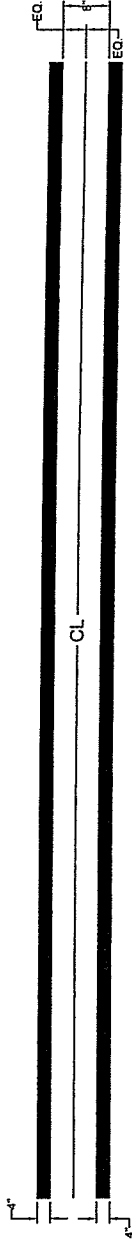

DOUBLE NO-PASSING
YELLOW

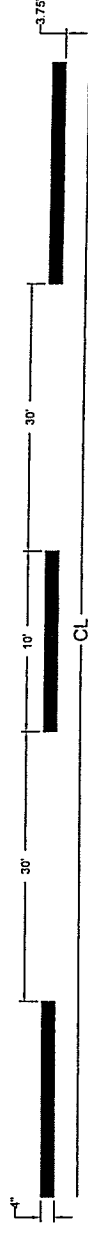

BROKEN CENTERLINE
YELLOW

JASPER COUNTY ENGINEERING DEPARTMENT
DESIGN FOR

PCC OVERLAY - UNBONDED
PAVEMENT MARKINGS

PROJECT NO. JL 07-17-19

DISTRICTS

JL 07-17-19

STBG-SWAP-C050(125)-FG-50

Tuesday, October 1, 2019 the Jasper County Board of Supervisors met in regular session at 9:30 a.m. Supervisors Talsma, Cupples and Carpenter present and accounted for; Chairman Carpenter presiding.

Engineer, Russ Stutt presented the Permit to Apply Alternative Dust Control on a Jasper County Roadway. This would address applying shingles or other asphalt alternatives.

Motion by Talsma and seconded by Cupples to approve the Permit to Apply Alternative Dust Control on a Jasper County Roadway.

YEA: CUPPLES, TALSMA, CARPENTER

Vicki Wade, representing Destination Downtown requested the use of the County Parking lot for vendors to set up for a special event on October 24, 2019 from 6:00pm to 9:00pm.

Motion by Talsma and seconded by Cupples to approve Destination Downtown to utilize the County parking lot for vendor set up on October 24, 2019 from 6:00pm to 9:00pm.

YEA: CUPPLES, TALSMA, CARPENTER

Motion by Talsma and seconded by Cupples to approve the 4-H Festival of Trees to set up inside the Courthouse on November 25, 2019 and take down on December 30, 2019.

YEA: CUPPLES, TALSMA, CARPENTER

Motion by Cupples and seconded by Talsma to approve claims for the period ending 10/01/2019.

YEA: TALSMA, CUPPLES, CARPENTER

Motion by Cupples and seconded by Talsma to approve Board of Supervisors minutes for 09/24/2019.

YEA: CUPPLES, TALSMA, CARPENTER

There were no Board appointments.

Motion by Talsma and seconded by Cupples to go into closed session in accordance with Iowa Code Section 22.7(50) regarding County Policy on Security and Emergency Preparedness and Iowa Code Section 21.5(i) Employee Evaluation for the County Engineer.

YEA: CUPPLES, CARPENTER, TALSMA.

Motion by Cupples and seconded by Talsma to go back into open session.

YEA: CUPPLES, CARPENTER, TALSMA

Motion by Cupples and seconded by Carpenter to carry out the safety measures as discussed in the closed session.

YEA: CUPPLES, CARPENTER

NAY: TALSMA

Motion by Cupples and seconded by Talsma to go back into closed session per Iowa Code Section 21.5(i) Employee Evaluation for the County Engineer.

Motion by Talsma and seconded by Cupples to go back into open session.

YEA: CUPPLES, CARPENTER, TALSMA

Motion by Talsma and seconded by Cupples to adjourn the Tuesday, October 1, 2019 meeting of the Jasper County Board of Supervisors.

YEA: CARPENTER, CUPPLES, TALSMA

Susan Young, Auditor Representative

Denny Carpenter, Chairman