



BOARD OF SUPERVISORS

PO Box 944, Newton, IA Phone: 641-792-7016 Fax: 641-792-1053

Denny Stevenson

Doug Cupples

Brandon Talsma

March 12, 2024

9:30 a.m.

www.jasperia.org

Live Stream: <https://zoom.us/j/8123744948>

Meeting ID: 812 374 4948

Dial In: +1-646-931-3860

-Anyone that has an item on the agenda must appear in person for the Board to consider it.-

8:30 AM Canvass for the March 5, 2024, City of Mingo's Special Election Results – Taylor Springer

Pledge of Allegiance



Item 1 Public Hearing - Engineer – Mike Frietsch

- a) 2025 Secondary Roads Budget

Item 2 Engineer – Mike Frietsch

- a) Approval of Plans for Quicksilver Project No. FM-C050(138)—55-50
- b) Approval of Plans for Poplar Avenue Project No. FM-C050(139)—55-50
- c) Set Public Hearing Dates for Vacation of Alley Right-of-Way adjacent to PIN 023238001 on Main Street in Ira, Iowa.
(Recommended Dates & Time: March 26th, April 2nd, & April 9th, 2024, at 9:30 am in the Board of Supervisors Room)
- d) Set Public Hearing Dates for Vacation of Alley Right-of-Way adjacent to PIN 023238002 on Main Street in Ira, Iowa.
(Recommended Dates & Time: March 26th, April 2nd, & April 9th, 2024, at 9:30 am in the Board of Supervisors Room)
- e) Set Public Hearing Dates for Vacation of Alley Right-of-Way adjacent to PIN 023238003 on Main Street in Ira, Iowa.
(Recommended Dates & Time: March 26th, April 2nd, & April 9th, 2024, at 9:30 am in the Board of Supervisors Room)

Item 3 Human Resources – Dennis Simon

- a) Hourly Non-Bargaining Pay Plan 2024-2025
- b) Salaried Non-Department Head Pay Plan 2024-2025
- c) Revised Wage Policy

Continue to Page 2



BOARD OF SUPERVISORS

PO Box 944, Newton, IA Phone: 641-792-7016 Fax: 641-792-1053

Page 2

Item 4 Community Development – Kevin Luetters

- a) Set Public Hearing for Ordinance #40D Jasper County Building Regulations
(Recommended Dates & Time: March 26th, April 2nd, & April 9th, 2024, at 9:30 am in the Board of Supervisors Room)

Item 5 Conservation – Keri Van Zante

- a) Easement with IRUA for new Waterline at Mariposa Campground

Item 6 Resolution for Expressing Support for Improvements to the Water Distribution System in Sully, Iowa, and Support for a Community Project Funding Application

Item 7 Resolution Approving Department Head Salaries for 2024-2025

Item 8 Approval of Claims Paid through 03/12/24

Item 9 Approval of Board of Supervisors Minutes for March 5, 2024

Item 10 Board Appointments

PUBLIC INPUT & COMMENTS

Item 11 Public Hearing – Engineer – Mike Frietsch

- a) Fiscal Year 2025 County 5-Year Program

Iowa Department of Transportation SECONDARY ROADS BUDGET

County: **Jasper County**
Fiscal Year: **2025**
Version: **Original**

COUNTY CERTIFICATION

This Secondary Road Budget was adopted by the Board of Supervisors on _____

Date

ATTESTED

County Auditor

Date

County Engineer

Date

Chairperson, Board of Supervisors

Date

IOWA DOT BUDGET APPROVALS

Recommended Approval: _____
OLS Reviewer

Date

Approval: _____
Director of Local Systems

Date

SECONDARY ROADS BUDGET



		Actual Receipts Prior Years		Estimated Receipts	
		2 nd Prior	1 st Prior	Current	Next
		FY 2022	FY 2023	FY 2024	FY 2025
1. County Auditor's Beginning Balance		\$7,279,479.72	\$8,902,978.03	\$9,258,365.89	\$6,778,034.15
Receipts from Property Tax Levies	0.00000 Dollars on all taxable property in county except on property within cities and towns. (Max. \$3.00375)	\$3,079,845.07	\$3,696,037.52	\$2,352,031.00	\$2,352,031.00
	0.00000 Dollars on all taxable property in the county. (Max. \$0.16875)				
2A. Local Option Sales Tax		\$150,000.00	\$493,600.00	\$0.00	\$0.00
3. Regular Road Use Tax Received	(Doesn't include transfer of local R.U.T. to FM account for const. on FM routes)	\$5,609,642.10	\$5,732,824.88	\$5,338,183.00	\$5,488,984.00
3b. Amount for 306.4(a3)	(Senate File 451 - FM Ext. in City <=500)	\$38,846.43	\$38,300.16	\$36,156.26	\$36,990.64
3c. Time 21		\$699,789.89	\$661,235.32	\$651,881.00	\$651,400.00
4. RISE Funds		\$0.00	\$0.00	\$0.00	\$0.00
5. FA Bridge Replacement Funds		\$0.00	\$0.00	\$0.00	\$0.00
5a. SWAP Bridge Replacement Funds		\$0.00	\$0.00	\$0.00	\$0.00
6. Proposed transfer of FM funds to Local Secondary Fund.(Section 309.10)		\$0.00	\$0.00	\$0.00	\$0.00
7. Tax Refunds (-) and/or Credits (+).(Section 309.10 - Code of Iowa)		\$0.00	\$0.00	\$0.00	\$0.00
8. Miscellaneous Receipts <i>Donations, sale of used materials, Special Assessments, etc</i> <i>Itemized for 2025</i>	Culvert, Bridge and Sign Damage Reimbursements			\$1,000.00	\$500.00
	Dust Control, Jury Duty and Maps			\$10,000.00	\$15,000.00
	Fuel Dividends and Usage Reimbursement			\$122,000.00	\$125,000.00
	Miscellaneous/Rock Reimb.			\$15,000.00	\$15,000.00
	Permits			\$42,500.00	\$42,500.00
	All Other	\$125,757.23	\$259,721.02	\$40,000.00	\$42,000.00
9. Total Miscellaneous Receipts		\$125,757.23	\$259,721.02	\$230,500.00	\$240,000.00
10. TOTAL RECEIPTS		\$16,983,360.44	\$19,784,696.93	\$17,867,117.15	\$15,547,439.79
11. Road Use Tax Funds or other local funds not transferred to Secondary Roads to be transferred to FM fund for construction.		0	0	\$0.00	\$0.00

SECONDARY ROADS BUDGET



	Actual Expenditures Prior Years		Estimated Expenditures	
	Prior 2	Prior 1	Current	Next
	FY 2022	FY 2023	FY 2024	FY 2025
70X * Administration and Engineering				
700 Administration Expenditures	\$291,958.89	\$343,752.85	\$364,668.00	\$385,997.00
701 Engineering Expenditures	\$436,608.17	\$364,484.27	\$465,712.00	\$452,887.00
TOTAL ADMINISTRATION AND ENGINEERING	\$728,567.06	\$708,237.12	\$830,380.00	\$838,884.00
020* Construction				
Adjusted Construction Program Expenditures (300) on FM and Local Sec. Roads <i>(With other than FM funds ---See Accomplishment Year projects)</i>	\$559,266.06	\$535,296.66	\$920,000.00	\$855,000.00
71X* Roadway Maintenance				
710 Bridges and Culverts (420, 430)	\$348,786.69	\$375,545.41	\$395,631.00	\$392,553.00
711 Roads (4250, 460, 480)	\$3,217,802.50	\$3,587,873.76	\$4,794,126.00	\$5,283,952.00
712 Snow and Ice Control (520)	\$366,977.79	\$513,409.09	\$487,433.00	\$513,461.00
713 Traffic Controls (590)	\$226,902.97	\$227,883.96	\$322,022.00	\$324,355.00
714 Road Clearing (490)	\$361,677.31	\$305,326.42	\$394,448.00	\$395,211.00
TOTAL ROADWAY MAINTENANCE	\$4,522,147.26	\$5,010,038.64	\$6,393,660.00	\$6,909,532.00
72X * General Roadway				
720 New Equipment (610)	\$510,325.04	\$2,272,827.18	\$870,000.00	\$250,000.00
721 Equipment Operations (620, 630, 650)	\$1,549,911.20	\$1,513,158.46	\$1,849,139.00	\$1,704,877.00
722 Tools, Materials and Supplies (655, 660, 670, 680, 690)	\$138,475.44	\$372,406.61	\$187,240.00	\$139,400.00
723 Real Estate and Buildings (800)	\$71,690.35	\$114,366.37	\$38,664.00	\$525,470.00
TOTAL GENERAL ROADWAY	\$2,270,402.03	\$4,272,758.62	\$2,945,043.00	\$2,619,747.00
TOTAL EXPENDITURES (70X + 020 + 71X + 72X)	\$8,080,382.41	\$10,526,331.04	\$11,089,083.00	\$11,223,163.00
County Auditor's balance at end of fiscal year	\$8,902,978.03	\$9,258,365.89	\$6,778,034.15	\$4,324,276.79
TOTAL (Must equal receipts) [Does not include transfer of Road Use Tax to FM Fund]	\$16,983,360.44	\$19,784,696.93	\$17,867,117.15	\$15,547,439.79



PROJECT NUMBER: FM-C050(138)-55-50
JASPER COUNTY HMA RESURFACING WITH MILLING
LETTING DATE: 08/20/24

LEGEND

- DIVIDED HIGHWAY 
- PAVED ROAD 
- BITUMINOUS ROAD 
- GRAVEL ROAD 
- EARTHROAD 

- INTERSTATE HIGHWAY 
- UNITED STATES HIGHWAY 
- STATE HIGHWAY 
- COUNTY HIGHWAY 

- RAILROAD 
- AIRPORT 
- HYDROLOGY 
- BRIDGE 

- STATE BOUNDARY 
- COUNTY BOUNDARY 
- CORPORATE LIMIT LINE 
- TOWNSHIP LINE 
- SECTION LINE 

IOWA
DEPARTMENT OF TRANSPORTATION
HIGHWAY DIVISION

PLANS OF PROPOSED IMPROVEMENT ON THE

FARM TO MARKET SYSTEMS

JASPER COUNTY

FM-CO50(138)-55-50

HMA RESURFACING WITH MILLING

Quicksilver Ave., from 1500' E of IA 163 SE 1.30 miles to Monroe CL

THE IOWA DEPARTMENT OF TRANSPORTATION STANDARD SPECIFICATIONS FOR HIGHWAY AND BRIDGE CONSTRUCTION, SERIES OF 2015, PLUS APPLICABLE GENERAL SUPPLEMENTAL SPECIFICATIONS, DEVELOPMENTAL SPECIFICATIONS, SUPPLEMENTAL SPECIFICATIONS AND THE SPECIAL PROVISIONS SHALL APPLY TO CONSTRUCTION WORK ON THIS PROJECT.

VALUE ENGINEERING SAVES. REFER TO ARTICLE 1105.15 OF SPECIFICATIONS.

THIS PROJECT IS COVERED BY THE IOWA DEPARTMENT OF NATURAL RESOURCES NPDES PERMIT NO. 2. THE CONTRACTOR SHALL CARRY OUT THE TERMS AND CONDITIONS OF GENERAL PERMIT NO. 2 AND THE STORM WATER POLLUTION PREVENTION PLAN WHICH IS PART OF THESE CONTRACT DOCUMENTS. REFER TO SECTION 2802 OF THE STANDARD SPECIFICATIONS FOR ADDITIONAL INFORMATION.

THE CONTRACTOR IS REQUIRED TO CONTACT "ONE CALL" AT (800) 292-8989 TO OBTAIN LOCATIONS FOR ALL EXISTING UTILITIES.

Approved _____ Date _____
Board of Supervisors

INDEX OF SHEETS	
NO.	DESCRIPTION
A.01	TITLE SHEET
B.01	GENERAL NOTES AND QUANTITIES
C.01-C.02	TYPICAL CROSS SECTION, INTERSECTION DETAIL
D.01	TRAFFIC CONTROL PLAN
E.01	PAVEMENT MARKINGS

TRAFFIC CONTROL PLAN	
ROADWAY WILL NOT BE OPEN TO TRAFFIC. THE CONTRACTOR SHALL INSTALL BARRICADES AND SAFETY FENCING AROUND THE CONSTRUCTION OPERATIONS AS NECESSARY TO PROTECT THE PUBLIC.	

MILEAGE SUMMARY				
DIV.	LOCATION		LIN. FT.	MILES
1	BEG. STA. 10211+50	END STA. 10281+18	6898.00	1.30

STANDARD ROAD PLANS					
THE FOLLOWING STANDARD PLANS SHALL BE CONSIDERED APPLICABLE TO CONSTRUCTION WORK ON THIS PROJECT					
STANDARD	ISSUED	STANDARD	ISSUED	STANDARD	ISSUED
PM-110	04-16-24				
PV-3	04-16-19				
PV-301	04-21-20				
TC-252	04-21-20				

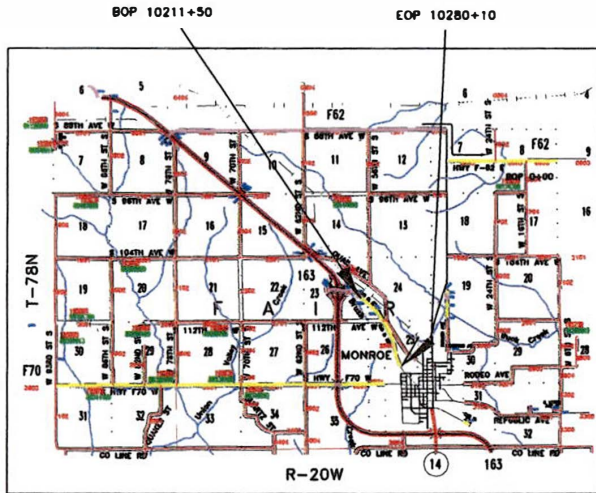

PROJECT LOCATION
VICINITY MAP



SCALES: AS NOTED
2020 AADT 11380 V.P.D.



I HEREBY CERTIFY THAT THIS ENGINEERING DOCUMENT WAS PREPARED BY ME OR UNDER MY DIRECT PERSONAL SUPERVISION AND THAT I AM A DULY LICENSED PROFESSIONAL ENGINEER UNDER THE LAWS OF THE STATE OF IOWA.

BY: _____ DATE: _____

MICHAEL FRIESCH, P.E. 26831
MY LICENSE RENEWAL DATE IS DECEMBER 31, 2024
SHEETS COVERED BY THIS SEAL: A.01 TO E.01

ESTIMATED QUANTITIES

REF. NO.	ITEM CODE	DESCRIPTION	UNIT	QUANTITY
1.	2102-2713090	EXCAVATION, CLASS 13, WASTE	CY	168.4
2.	2126-8273058	RECLAIMING PRESENT SURFACE MATERIAL	CY	98.4
3.	2121-7425010	GRANULAR SHOULDERS, TYPE "B",	TON	588
4.	2212-0475085	CLEANING AND PREPARATION OF BASE	MILE	1.32
5.	2212-8070310	PATCHES, FULL DEPTH	SY	188
6.	2212-8070330	PATCHES BY COUNT (REPAIR)	EACH	12
7.	2214-5145150	PAVEMENT SCARIFICATION	SY	18826.7
8.	2303-0002380	HMA INTERLAYER BASE COARSE, 3/8 IN. MIX EHT	TON	1578
9.	2303-1031750	HMA STANDARD TRAFFIC BASE COURSE, 3/4 IN. MIX	TON	128
10.	2303-1043500	HMA, HT, SURFACE COURSE, 1/2 IN. MIX, NO SP. FRIC. REQ.	TON	1697
11.	2303-1258283	ASPHALT BINDER, PG 58-28S, STANDARD TRAFFIC	TON	8
12.	2303-1258284	ASPHALT BINDER, PG 58-28H, HT	TON	102
13.	2303-1258348	ASPHALT BINDER, PG 58-34E, EHT	TON	128
14.	2303-8911000	HMA PAVEMENT SAMPLES	EACH	1
15.	2527-9283117	PAINTED PAVEMENT MARKING, DURABLE	STA	213
16.	2527-9270111	GROOVE CUT - PAVT MARK	STA	213
17.	2528-2518000	SAFETY CLOSURE	EACH	4
18.	2528-8445110	TRAFFIC CONTROL	LS	1
19.	2533-4880005	MOBILIZATION	LS	1

GENERAL NOTES

- THE CONTRACTOR SHALL CONTAIN ALL WORK TO THE EXISTING RIGHT OF WAY UNLESS WRITTEN PERMISSION IS OBTAINED FROM PERSPECTIVE PROPERTY OWNER AND PRESENTED TO THE CONTRACTING AUTHORITY.
- ALL RUBBLE AND DEBRIS GENERATED BY REMOVAL CONSTRUCTION OPERATIONS SHALL BE CLEANED UP AND DISPOSED OF BY THE CONTRACTOR IN COMPLIANCE WITH APPLICABLE FEDERAL, STATE, AND LOCAL REQUIREMENTS.
- ANY EXISTING FIELD TILE THAT IS DISTURBED DURING CONSTRUCTION SHALL BE REPLACED OR REPAIRED TO FUNCTION AS WELL OR BETTER THAN ORIGINAL BY THE CONTRACTOR AT THEIR EXPENSE.
- IT WILL BE THE CONTRACTOR'S RESPONSIBILITY TO NOTIFY ALL UTILITIES ON THIS PROJECT PRIOR TO BEGINNING WORK, AS PER ARTICLE 1107.5 OF THE STANDARD SPECIFICATIONS.
- STANDARD SPECIFICATION SECTIONS ASSOCIATED WITH ITEM CODES SHALL APPLY UNLESS OTHERWISE NOTED.
- 911 SIGNS SHALL NOT BE DISTURBED UNLESS THEY INTERFERE WITH CONSTRUCTION. DISTURBED 911 SIGNS SHALL BE REPLACED BY OTHERS.
- CONTRACTOR SHALL NOTIFY COUNTY 2 WEEKS PRIOR TO STARTING CONSTRUCTION.
- NO CLEANOUTS WILL BE ALLOWED ON OR ALONG ANY CITY, COUNTY, OR STATE ROADS.

REF. NO.

- 1. ITEM IS TO BE USED FOR EXCAVATION FOR CONSTRUCTION OF INTERSECTION RUNOUTS.
- 2. QUANTITY IS BASED ON TOP 4" OF MATERIAL FROM FILLET AREA OF S 112TH AVE WEST. REMAINDER OF QUANTITY WILL COME FROM MILLINGS, AND BE USED AS BASE MATERIAL FOR BOTH FILLETS
- 4. ITEM TO BE USED FOR MILL AND OVERLAY AREAS.
- 6. BID QUANTITY IS ASSUMED AT A RATE OF 1% OF THE TOTAL AREA. FIELD LOCATED AND COORDINATE WITH JASPER COUNTY ENGINEER ON FINAL LOCATIONS.
- 7. SCARIFICATION WILL BE 2 INCHES DEEP, 24 FEET WIDE AND 100 FEET LONG AT THE B.O.P AND THE E.O.P. THE HMA WILL THEN BE PLACED BACK GRADUALLY WITH EACH LIFT PLACED ON THE MAINLINE AT 24 FEET WIDE, SO AS NOT TO LEAVE A BUMP. SCARIFICATION WILL BE MILLED DOWN TO A MINIMUM 3/8" THRU OVERLAY. MILLINGS TO BE COME PROPERTY OF THE CONTRACTOR.
- 8-10. REFER TO C SHEETS FOR TYPICAL SECTIONS. THIS ITEM REQUIRES CERTIFIED PLANT INSPECTIONS BY THE CONTRACTOR.
- 11-12. QUANTITY IS BASED ON 8% BY WEIGHT OF THE TONS OF MIX.
- 13. QUANTITY IS BASED ON 8% BY WEIGHT OF THE TONS OF MIX.
- 14. HMA CERTIFIED PLANT INSPECTION REQUIRED, CONTRACTOR SHALL COORDINATE WITH JASPER COUNTY ENGINEER.
- 15-16. REFER TO E.01

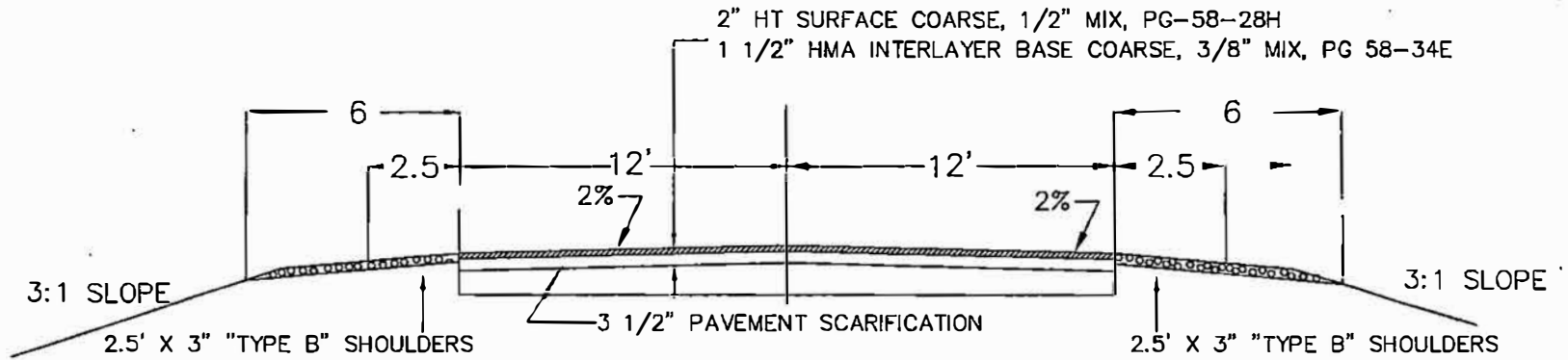

10211+50 TO 10280+10

CONTRACTOR TO CUT A BUTT-JOINT

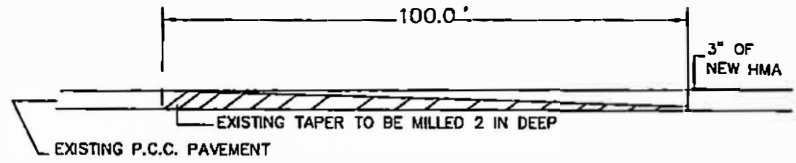

BEGINNING OF PROJECT

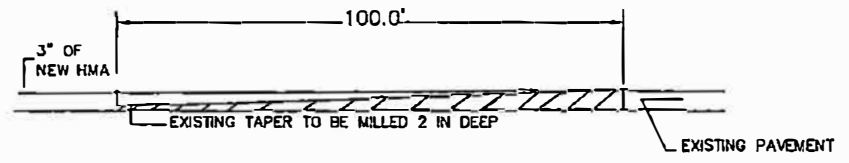

END OF PROJECT

JASPER COUNTY ENGINEERING	
DEPARTMENT	
HMA RESURFACING WITH MILLING	
TYP. CROSS SECTION	
DESIGNED BY	LAST REVISED
2/14/24	03/31/24
PROJECT NO. FM-C050(138)--55-50	

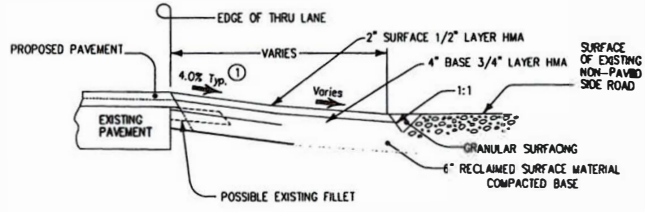

Special shaping of existing surfaces prior to placement of HMA or filter extension may be required by the Engineer and is incidental to other work on the project.
 Pavement quantities included with metric quantities.
 ① Match existing slope.

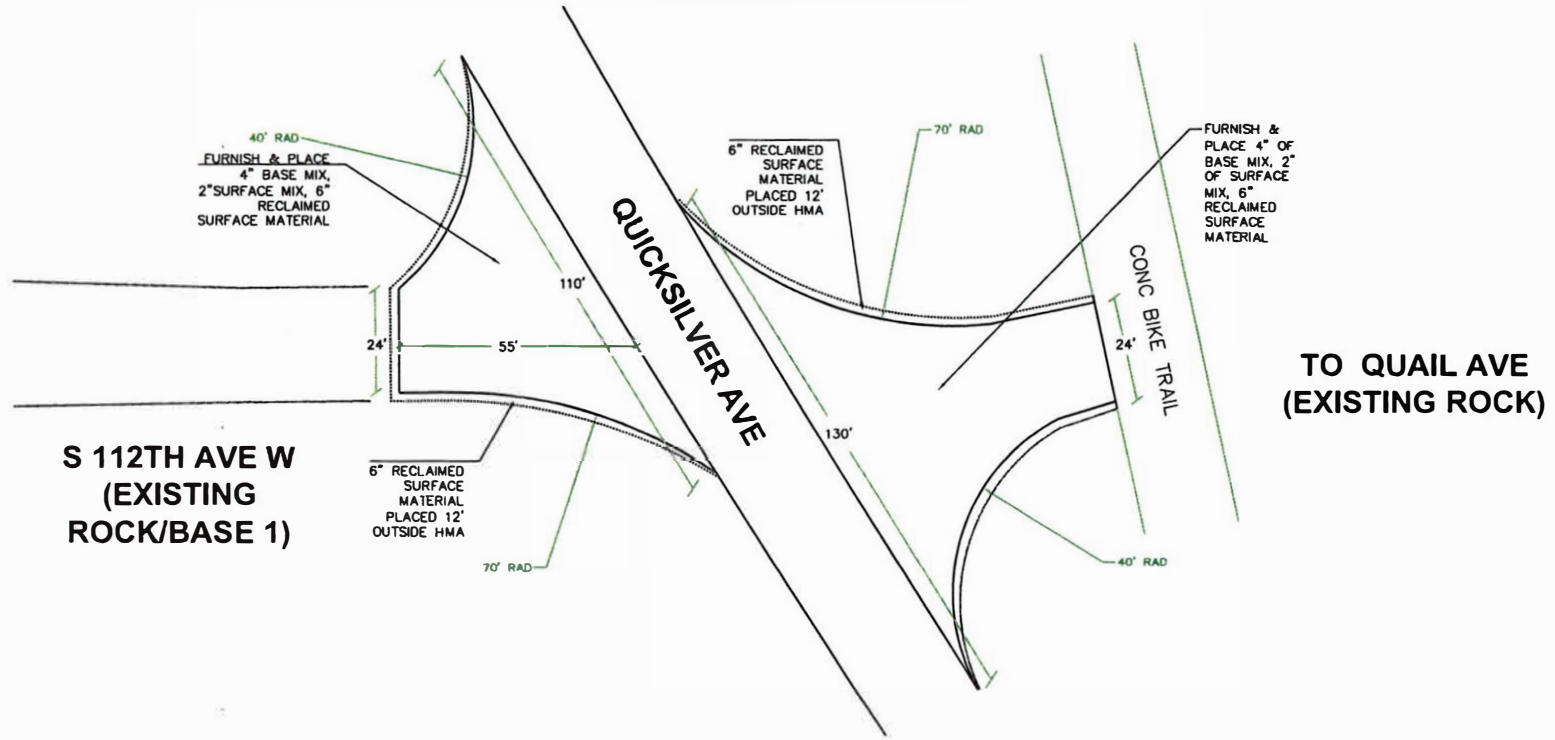

TO QUAIL AVE
(EXISTING ROCK)

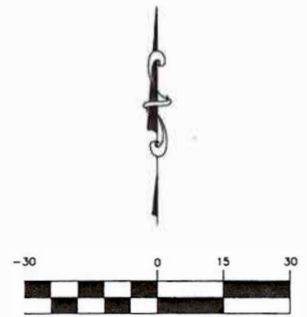

INTERSECTION QUANTITIES										JASPER 06-10-13	
ROAD NAME	PCC	HMA	GRAN. SURF	GRAN. SHLDR	GRAN. SHLDR	RECLAIM.	S.M.				
	(SY)	(CY)	(IN.)	(IN.)	(IN.)	(IN.)	(IN.)	(IN.)	(IN.)	CY	
S 112th Ave W	0	0	2	29	0-9	0	3	5	6	43.72	
S 112th Ave W	0	0	4	56.49	0-9	0	3	5	0	0	

INTERSECTION QUANTITIES										JASPER 06-10-13	
ROAD NAME	PCC	HMA	GRAN. SURF	GRAN. SHLDR	GRAN. SHLDR	RECLAIM.	S.M.				
	(SY)	(CY)	(IN.)	(IN.)	(IN.)	(IN.)	(IN.)	(IN.)	(IN.)	CY	
TO QUAIL AVE	0	0	2	36.86	0-9	0	3	5	6	55.39	
TO QUAIL AVE	0	0	4	71.56	0-9	0	3	5	0	0	

JASPER COUNTY ENGINEERING DEPARTMENT	
HMA MILLING & OVERLAY	
TYPICAL CROSS SECTIONS AND DETAILS	
DESIGNED BY	2/14/24
LAST REVIEWED	3/31/24
PROJECT NO.	FM-C050(138)--55-50

HMA RESURFACING WITH MILLING

JASPER COUNTY

FM-C050(138)--55-50

SHEET C.02

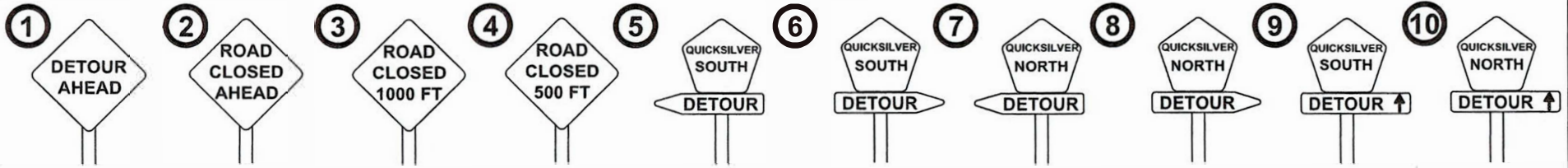

DETOUR ROUTE SIGNS
SCALE: NOT TO SCALE

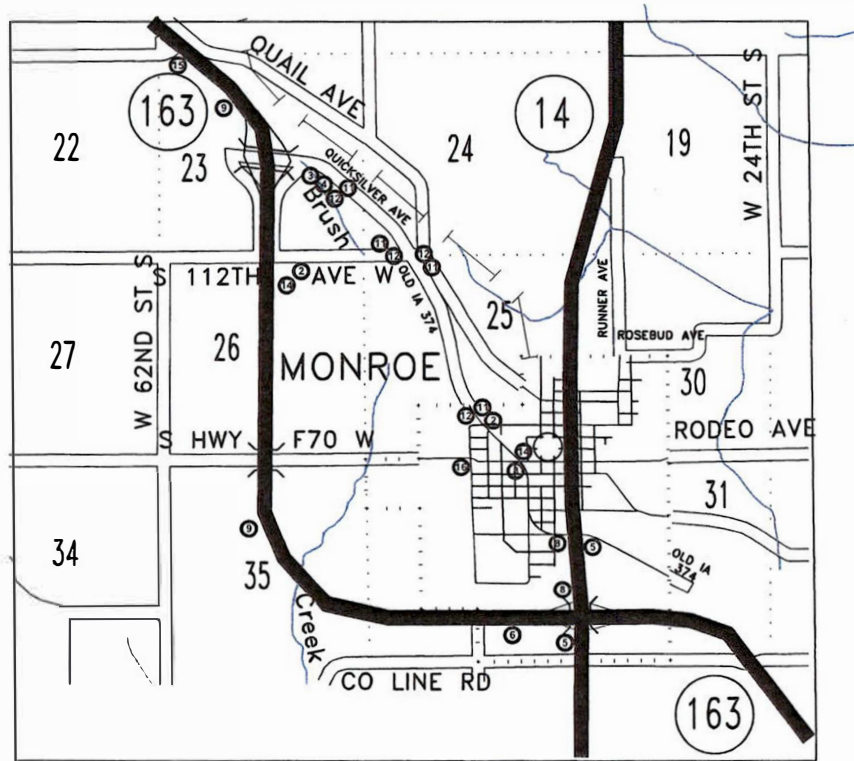
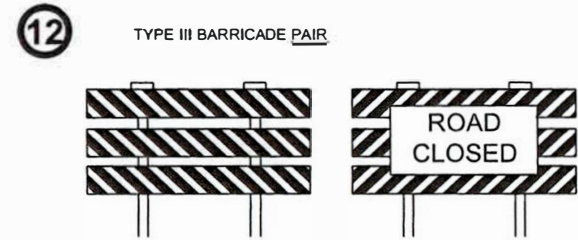

TABULATION	
1	0 EACH
2	2 EACH
3	1 EACH
4	1 EACH
5	2 EACH
6	1 EACH
7	0 EACH
8	3 EACH
9	2 EACH
10	0 EACH
11	4 EACH
12	4 EACH
13	0 EACH
14	2 EACH
15	1 EACH
16	1 EACH

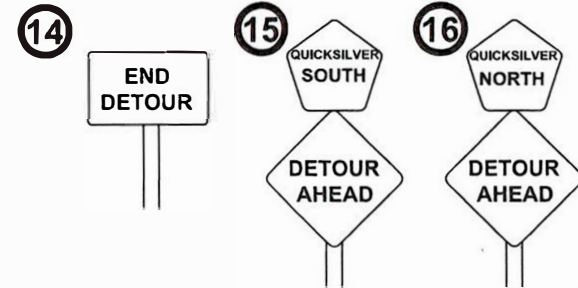

JASPER COUNTY ENGINEERING DEPARTMENT	
DESIGN FOR	
HMA RESURFACING WITH MILLING	
TRAFFIC CONTROL PLAN	
DESIGNED BY	LAST REVISED
2/14/24	03/31/24
PROJECT NO.	
FM-C050(138)-55-50	

STANDARD TYPES OF PAVEMENT MARKINGS

SCALE: NOT TO SCALE



EDGE LINE
WHITE

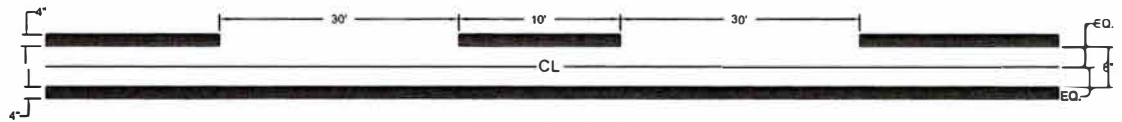

SINGLE NO-PASSING
YELLOW

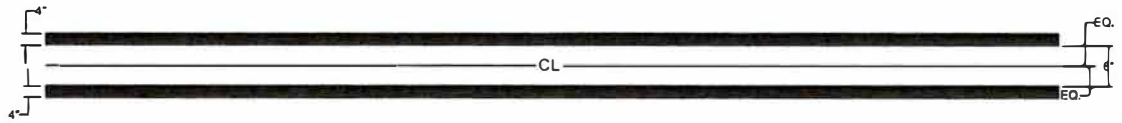

DOUBLE NO-PASSING
YELLOW



BROKEN CENTERLINE
YELLOW

Road ID		Station to Station	Length (STA)	Loc. or Trac.	Marking Type	Side	REV*	OCV*	MPH**	ELW*	ELR*	CVL*	Length by Line Type (In/Feet)										Remarks			
L	R						STA	STA	STA	STA	STA	STA	STA	STA	STA	STA	STA	STA	STA	STA	STA	STA	STA	STA		
QuickSilver		10211+50.00	10215+66.00	4.16	BOTH																					
QuickSilver		10215+66.00	10222+84.00	17.18	BOTH																					
QuickSilver		10222+84.00	10240+93.00	8.00	BOTH																					
QuickSilver		10240+93.00	10241+96.00	1.63	BOTH																					
QuickSilver		10241+96.00	10259+43.00	17.47	BOTH																					
QuickSilver		10259+43.00	10260+24.00	0.83	BOTH																					
QuickSilver		10260+24.00	10268+51.00	8.30	BOTH																					
QuickSilver		10268+51.00	10271+18.04	17.64	BOTH																					
QuickSilver		10271+18.04	10236+93.00	25.43	SB																					
QuickSilver		10236+93.00	10237+07.00	25.57	NB																					
QuickSilver		10237+07.00	10281+18.04	43.25	SB																					
QuickSilver		10281+18.04	10281+18.04	42.81	NB																					
SURTOTALS																										
QUANTITY FACTORS																										
TOTALS																										

JASPER COUNTY ENGINEERING DEPARTMENT
DESIGN FOR
HMA RESURFACING WITH MILLING

PAVEMENT MARKINGS

DESIGNED BY: 2/14/24
LAST REVISED: 03/31/24
PROJECT NO: FM-C050(138)-55-50

PROJECT NUMBER: F C050(13) -55 50
 JASPER COUNTY HMA RESURFACING WITH MILLING
 JASPER COUNTY HMA RESURFACING WITH MILLING

LEGEND

- DIVIDED HIGHWAY
- PAVED ROAD
- BITUMINOUS ROAD
- GRAVEL ROAD
- EARTH ROAD

- INTERSTATE HIGHWAY
- UNITED STATES HIGHWAY
- STATE HIGHWAY
- COUNTY HIGHWAY

- RAILROAD
- AIRPORT
- HYDROLOGY
- BRIDGE

- STATE BOUNDARY
- COUNTY BOUNDARY
- CORPORATE LIMIT LINE
- TOWNSHIP LINE
- SECTION LINE



IOWA
DEPARTMENT OF TRANSPORTATION
HIGHWAY DIVISION
 PLANS OF PROPOSED IMPROVEMENT ON THE
FARM TO MARKET SYSTEMS
JASPER COUNTY
 FM-CO50(139)-55-50
HMA RESURFACING WITH MILLING

Poplar Ave, From 1487' E of W 116th St. 0.7 miles to Prairie City CL

INDEX OF SHEETS

NO.	DESCRIPTION
A.01	GENERAL NOTES AND QUANTITIES
B.01	TYPICAL CROSS SECTION, INTERSECTION DETAIL
C.01	TRAFFIC CONTROL PLAN
D.01	RAFFIC CONTROL PLAN
E.01	PAVEMENT MARKINGS

TRAFFIC CONTROL PLAN

ROADWAY WILL NOT BE OPEN TO TRAFFIC. THE CONTRACTOR SHALL INSTALL BARRICADES AND SAFETY FENCING AROUND THE CONSTRUCTION OPERATIONS AS NECESSARY TO PROTECT THE PUBLIC.

MILEAGE SUMMARY

DIV.	LOCATION	LIN. FT.	MILES
BEG. STA. 5225+81	END STA 5265+11	3930	0.74

STANDARD ROAD PLANS

THE FOLLOWING STANDARD PLANS SHALL BE CONSIDERED APPLICABLE TO CONSTRUCTION WORK ON THIS PROJECT

STANDARD	ISSUED	STANDARD	ISSUED	STANDARD	ISSUED
PM-110	04-16-24				
PV-3	04-16-19				
PV-301	04-21-20				
TC-252	04-21-20				

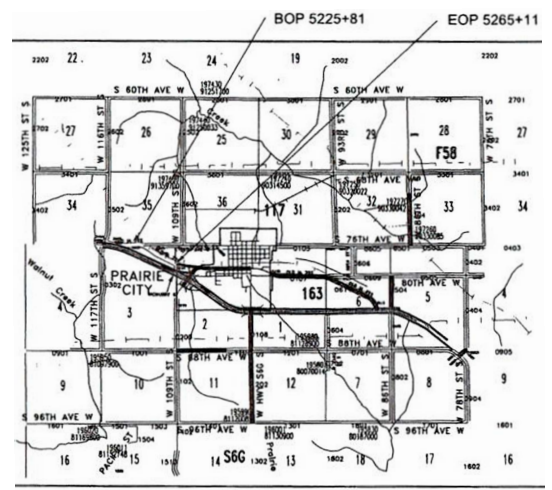

THE IOWA DEPARTMENT OF TRANSPORTATION STANDARD SPECIFICATIONS FOR HIGHWAY AND BRIDGE CONSTRUCTION, SERIES OF 2015, PLUS APPLICABLE GENERAL SUPPLEMENTAL SPECIFICATIONS, DEVELOPMENTAL SPECIFICATIONS, SUPPLEMENTAL SPECIFICATIONS AND THE SPECIAL PROVISIONS SHALL APPLY TO CONSTRUCTION WORK ON THIS PROJECT.

VALUE ENGINEERING SAVES. REFER TO ARTICLE 1105.15 OF SPECIFICATIONS.

THIS PROJECT IS COVERED BY THE IOWA DEPARTMENT OF NATURAL RESOURCES NPDES PERMIT NO. 2. THE CONTRACTOR SHALL CARRY OUT THE TERMS AND CONDITIONS OF GENERAL PERMIT NO. 2 AND THE STORM WATER POLLUTION PREVENTION PLAN WHICH IS PART OF THESE CONTRACT DOCUMENTS. REFER TO SECTION 2602 OF THE STANDARD SPECIFICATIONS FOR ADDITIONAL INFORMATION.

THE CONTRACTOR IS REQUIRED TO CONTACT 'ONE CALL' AT (800) 292-8989 TO OBTAIN LOCATIONS FOR ALL EXISTING UTILITIES.

Approved
Board of Supervisors

Date

PROJECT LOCATION VICINITY MAP



"NOT TO SCALE"

SCALES: AS NOTED
2022 AADT 620 V.P.D.



I HEREBY CERTIFY THAT THIS ENGINEERING DOCUMENT WAS PREPARED BY ME OR UNDER MY DIRECT PERSONAL SUPERVISION AND THAT I AM A DULY LICENSED PROFESSIONAL ENGINEER UNDER THE LAWS OF THE STATE OF IOWA.

BY: _____ DATE: _____

MICHAEL J. FRIETSCH, PE 26831
MY LICENSE RENEWAL DATE IS DEC. 31, 2024
SHEETS COVERED BY THIS SEAL: A.01-E.01



ESTIMATED QUANTITIES

REF. NO.	ITEM CODE	DESCRIPTION	UNIT	QUANTITY
1.	2121-7425010	GRANULAR SHOULDERS, TYPE "B",	TON	330
2.	2212-0475095	CLEANING AND PREPARATION OF BASE	MILE	0.74
3.	2212-5070310	PATCHES, FULL DEPTH	SY	105
4.	2212-5070330	PATCHES BY COUNT (REPAIR)	EACH	8
5.	2214-5145150	PAVEMENT SCARIFICATION	SY	10,924
6.	2303-0002380	HMA INTERLAYER BASE COARSE, 3/8 IN. MIX EHT	TON	889
7.	2303-1043500	HMA, HT, SURFACE COURSE, 1/2 IN. MIX, NO SP. FRIC. REQ.	TON	1183
8.	2303-1258284	ASPHALT BINDER, PG 58-28H, HT	TON	70
9.	2303-1258348	ASPHALT BINDER, PG 58-34E, EHT	TON	71
10.	2303-8911000	HMA PAVEMENT SAMPLES	EACH	1
11.	2315-8275025	CLASS "A" DRIVEWAY CRUSHED STONE	TON	60
12.	2527-9283117	PAINTED PAVEMENT MARKING, DURABLE	STA	145
13.	2527-9270111	GROOVE CUT - PAVT MARK	STA	145
14.	2528-2518000	SAFETY CLOSURE	EACH	3
15.	2528-8445110	TRAFFIC CONTROL	LS	1
16.	2533-4880005	MOBILIZATION	LS	1

GENERAL NOTES

-THE CONTRACTOR SHALL CONTAIN ALL WORK TO THE EXISTING RIGHT OF WAY UNLESS WRITTEN PERMISSION IS OBTAINED FROM PERSPECTIVE PROPERTY OWNER AND PRESENTED TO THE CONTRACTING AUTHORITY.

-ALL RUBBLE AND DEBRIS GENERATED BY REMOVAL CONSTRUCTION OPERATIONS SHALL BE CLEANED UP AND DISPOSED OF BY THE CONTRACTOR IN COMPLIANCE WITH APPLICABLE FEDERAL, STATE, AND LOCAL REQUIREMENTS.

-ANY EXISTING FIELD TILE THAT IS DISTURBED DURING CONSTRUCTION SHALL BE REPLACED OR REPAIRED TO FUNCTION AS WELL OR BETTER THAN ORIGINAL BY THE CONTRACTOR AT THEIR EXPENSE.

-IT WILL BE THE CONTRACTOR'S RESPONSIBILITY TO NOTIFY ALL UTILITIES ON THIS PROJECT PRIOR TO BEGINNING WORK, AS PER ARTICLE 1107.5 OF THE STANDARD SPECIFICATIONS.

-STANDARD SPECIFICATION SECTIONS ASSOCIATED WITH ITEM CODES SHALL APPLY UNLESS OTHERWISE NOTED.

-911 SIGNS SHALL NOT BE DISTURBED UNLESS THEY INTERFERE WITH CONSTRUCTION. DISTURBED 911 SIGNS SHALL BE REPLACED BY OTHERS.

-CONTRACTOR SHALL NOTIFY COUNTY 2 WEEKS PRIOR TO STARTING CONSTRUCTION.

-NO CLEANOUTS WILL BE ALLOWED ON OR ALONG ANY CITY, COUNTY, OR STATE ROADS.

-NO CLEANOUTS WILL BE ALLOWED IN DRIVEWAYS OR FIELD ENTRANCES UNLESS AGREED TO IN WRITING BY THE LANDOWNER.

REF. NO.

- 2. ITEM TO BE USED FOR MILL AND OVERLAY AREAS.
- 4. BID QUANTITY IS ASSUMED AT A RATE OF 1% OF THE TOTAL AREA. FIELD LOCATED AND COORDINATE WITH JASPER COUNTY ENGINEER ON FINAL LOCATIONS.
- 5. SCARIFICATION WILL BE 2 INCHES DEEP, 24 FEET WIDE AND 100 FEET LONG AT THE B.O.P AND THE E.O.P. THE HMA WILL THEN BE PLACED BACK GRADUALLY WITH EACH LIFT PLACED ON THE MAINLINE AT 24 FEET WIDE, SO AS NOT TO LEAVE A BUMP. SCARIFICATION WILL BE MILLED DOWN TO A MINIMUM 3/8" THRU OVERLAY. MILLINGS TO BE COME PROPERTY OF THE CONTRACTOR.
- 6-7. REFER TO C SHEETS FOR TYPICAL SECTIONS. THIS ITEM REQUIRES CERTIFIED PLANT INSPECTIONS BY THE CONTRACTOR.
- 8. QUANTITY IS BASED ON 8% BY WEIGHT OF THE TONS OF MIX.
- 9. QUANTITY IS BASED ON 8% BY WEIGHT OF THE TONS OF MIX.
- 10. HMA CERTIFIED PLANT INSPECTION REQUIRED, CONTRACTOR SHALL COORDINATE WITH JASPER COUNTY ENGINEER.
- 11. QUANTITY BASED ON 10 TON PER ENTRANCE.
- 12-13 REFER TO E.01

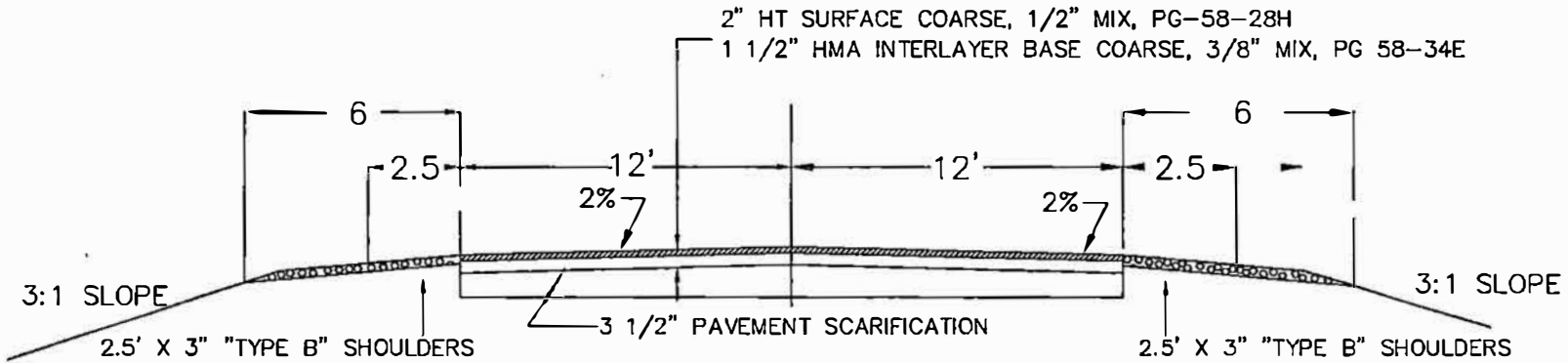

5225+81 TO 5265+11

CONTRACTOR TO CUT A BUTT-JOINT

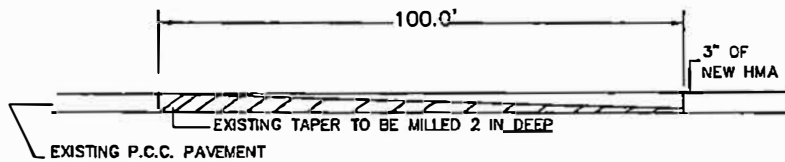

BEGINNING OF PROJECT

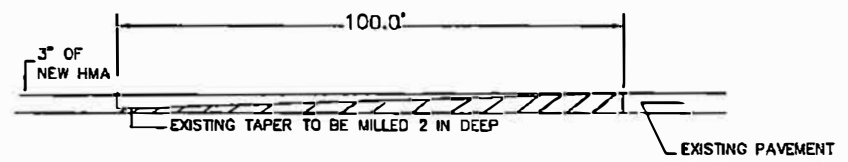

END OF PROJECT

JASPER COUNTY ENGINEERING	
DEPARTMENT 1	
HMA RESURFACING WITH MILLING	
TYP. CROSS SECTION	
DESIGNED BY	LAST REVISION
2/14/24	03/31/24
PROJECT NO. FM-C050(139)--55-50	

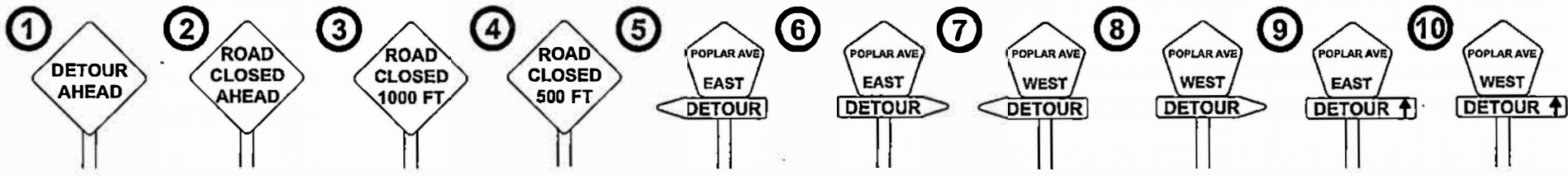

DETOUR ROUTE SIGNS
SCALE: NOT TO SCALE

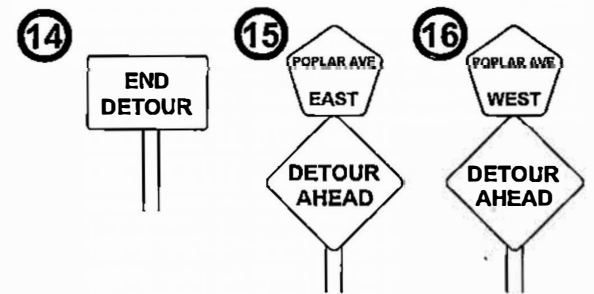
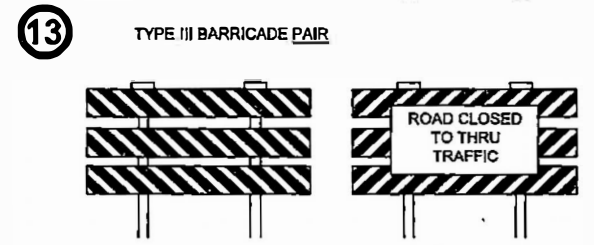
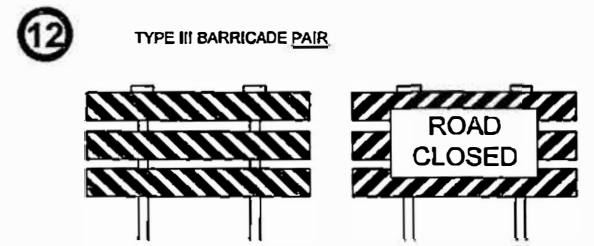

TABULATION	
1	2 EACH
2	2 EACH
3	3 EACH
4	3 EACH
5	2 EACH
6	1 EACH
7	0 EACH
8	2 EACH
9	0 EACH
10	0 EACH
11	1 EACH
12	1 EACH
13	2 EACH
14	2 EACH
15	0 EACH
16	0 EACH

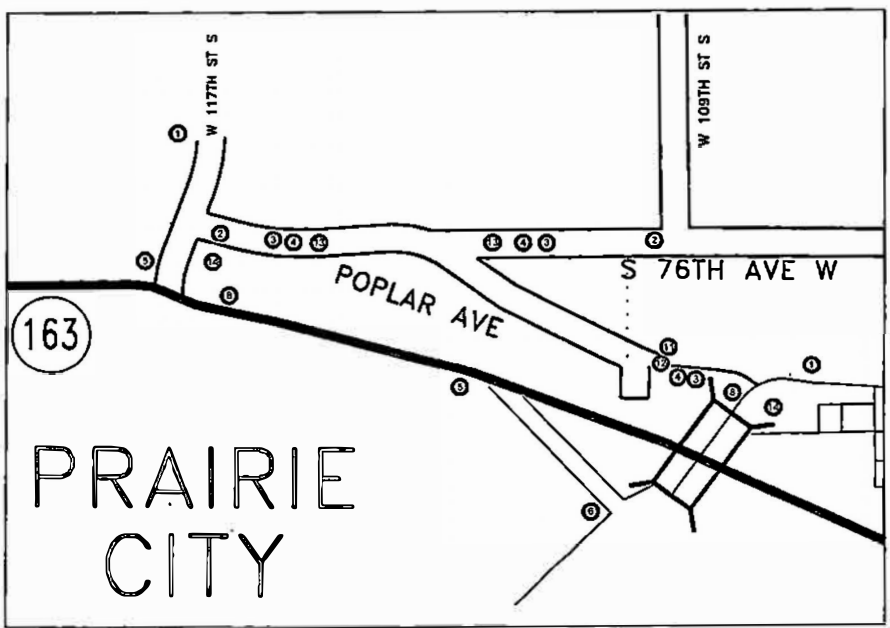

JASPER COUNTY ENGINEERING DEPARTMENT
DESIGN FOR
HMA RESURFACING WITH MILLING
TRAFFIC CONTROL PLAN
DESIGNED BY: 2/14/24
DATE REVISED: 03/31/24
PROJECT NO.: FM-C050(139)-55-50

STANDARD TYPES OF PAVEMENT MARKINGS
SCALE: NOT TO SCALE

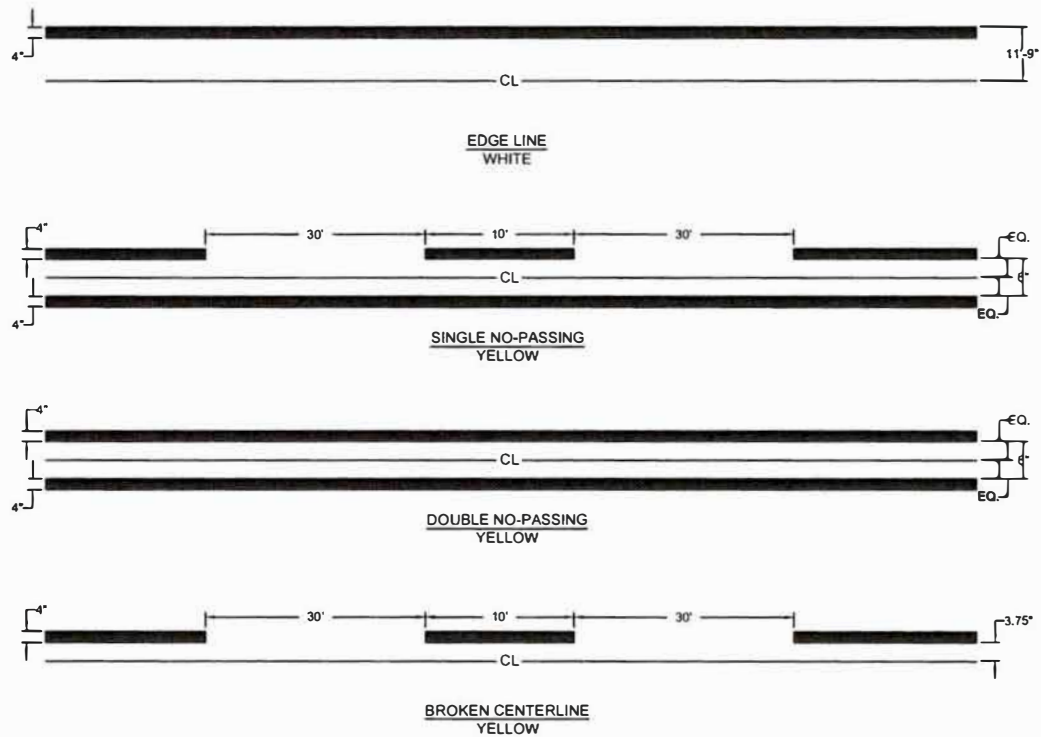

PAVEMENT MARKING LINE TYPES

Notes:
 *M14 - Paint on the same side of the roadway to mark existing markings near the project.
 **M14 - For existing (retrofit) only, the existing zone line will be omitted in the table.
 ***M14 - Factor of 1.00 as value includes number of 4-inch passes to cover median nose area.
 This Data Entry Sheet Fills Tab 08.32, effective 04-16-15

Legend:
 BCYL: Broken Centerline (Yellow) @ 4.25
 CCL: Edge Line Left (Yellow) @ 1.00
 DCYL: Double Centerline (Yellow) @ 2.00
 NPYL: No Passing Zone Line (Yellow) @ 1.25
 RL: Broken Lane Line (White) @ 0.25
 RL: Edge Line Right (White) @ 1.00

Road ID	Station to Station	Length (STA)	Dir. of Travel	Marking Type	Length by Line Type (Inches)													Remarks									
					E	L	R	STA	DCYL	NPYL	RL	RL	RL	STA	STA	STA	STA		STA	STA	STA						
Poplar	5275+61.00	5280+08.00	36.00	RTM																							
Poplar	5249+96.00	5255+11.00	15.21	BTM																							
Poplar	5225+01.00	5265+11.00	39.30	S																							
Poplar	5225+01.00	5238+31.00	12.50	RR																							
Poplar	5238+31.00	5240+01.00	1.70	RR																							
Poplar	5268+01.00	5269+11.00	25.10	RR																							
SUBTOTALS																											
QUANTITY FACTORS																											
TOTALS																											

JASPER COUNTY ENGINEERING DEPARTMENT
 DESIGN FOR
 HMA RESURFACING WITH MILLING
 PAVEMENT MARKINGS

DESIGNED BY: 2/14/24
 LAST REVISED: 03/31/24

PROJECT NO: FM-C050(139)-55-50

Effective: July 1, 2024

2024 - 2025 Hourly Non-Bargaining Pay Scale

Employees only receive their step increase on their anniversary

Employees at the top of their plan will receive 3.5% and will become a "Standard Rate" in the payroll system

		Step 1	Step 2	Step 3	Step 4	Step 5	Step 6	Step 7	Step 8	Step 9
Range	9	\$10.96	\$11.38	\$11.94	\$12.40	\$12.85	\$13.34	\$13.84	\$14.42	\$14.92
Range	10	\$11.42	\$11.82	\$12.44	\$12.88	\$13.28	\$13.74	\$14.21	\$14.70	\$15.18
Range	11	\$11.63	\$12.02	\$12.66	\$13.09	\$13.52	\$13.96	\$14.43	\$14.93	\$15.45
Range	12	\$11.82	\$12.20	\$12.88	\$13.28	\$13.74	\$14.21	\$14.70	\$15.18	\$15.71
Range	13	\$11.98	\$12.39	\$13.05	\$13.49	\$13.93	\$14.40	\$14.90	\$15.42	\$15.95
Range	14	\$12.21	\$12.63	\$13.30	\$13.75	\$14.23	\$14.71	\$15.20	\$15.73	\$16.29
Range	15	\$12.41	\$12.82	\$13.52	\$13.96	\$14.43	\$14.93	\$15.45	\$15.98	\$16.53
Range	16	\$12.60	\$13.04	\$13.72	\$14.20	\$14.68	\$15.17	\$15.69	\$16.23	\$16.81
Range	17	\$12.82	\$13.25	\$13.96	\$14.43	\$14.93	\$15.45	\$15.98	\$16.53	\$17.10
Range	18	\$13.04	\$13.48	\$14.20	\$14.68	\$15.17	\$15.69	\$16.23	\$16.81	\$17.40
Range	19	\$13.25	\$13.71	\$14.43	\$14.93	\$15.45	\$15.98	\$16.53	\$17.10	\$17.69
Range	20	\$13.51	\$13.96	\$14.71	\$15.20	\$15.73	\$16.29	\$16.85	\$17.44	\$18.06
Range	21	\$13.71	\$14.19	\$14.93	\$15.45	\$15.98	\$16.53	\$17.10	\$17.69	\$18.32
Range	22	\$13.96	\$14.44	\$15.20	\$15.73	\$16.29	\$16.85	\$17.44	\$18.06	\$18.71
Range	23	\$14.20	\$14.69	\$15.46	\$15.99	\$16.56	\$17.13	\$17.73	\$18.35	\$19.00
Range	24	\$14.46	\$14.97	\$15.74	\$16.30	\$16.86	\$17.45	\$18.07	\$18.72	\$19.37
Range	25	\$14.69	\$15.21	\$15.99	\$16.56	\$17.13	\$17.73	\$18.35	\$19.00	\$19.68
Range	26	\$14.97	\$15.49	\$16.30	\$16.86	\$17.45	\$18.07	\$18.72	\$19.37	\$20.06
Range	27	\$15.22	\$15.74	\$16.58	\$17.14	\$17.75	\$18.37	\$19.02	\$19.69	\$20.39
Range	28	\$15.47	\$16.01	\$16.85	\$17.44	\$18.06	\$18.71	\$19.36	\$20.05	\$20.77
Range	29	\$15.72	\$16.26	\$17.12	\$17.70	\$18.34	\$18.99	\$19.65	\$20.36	\$21.10
Range	30	\$16.03	\$16.60	\$17.45	\$18.07	\$18.72	\$19.37	\$20.06	\$20.79	\$21.52
Range	31	\$16.31	\$16.88	\$17.76	\$18.38	\$19.03	\$19.71	\$20.42	\$21.17	\$21.92

Effective: July 1, 2024

2024 - 2025 Hourly Non-Bargaining Pay Scale

Employees only receive their step increase on their anniversary

Employees at the top of their plan will receive 3.5% and will become a "Standard Rate" in the payroll system

		Step 1	Step 2	Step 3	Step 4	Step 5	Step 6	Step 7	Step 8	Step 9
Range	32	\$16.58	\$17.18	\$18.06	\$18.71	\$19.36	\$20.05	\$20.77	\$21.51	\$22.27
Range	33	\$16.89	\$17.50	\$18.40	\$19.06	\$19.74	\$20.46	\$21.20	\$21.95	\$22.73
Range	34	\$17.19	\$17.79	\$18.72	\$19.37	\$20.06	\$20.79	\$21.52	\$22.29	\$23.11
Range	35	\$17.48	\$18.10	\$19.03	\$19.71	\$20.42	\$21.17	\$21.92	\$22.70	\$23.51
Range	36	\$17.81	\$18.45	\$19.40	\$20.09	\$20.82	\$21.57	\$22.33	\$23.16	\$23.98
Range	37	\$18.11	\$18.76	\$19.72	\$20.43	\$21.18	\$21.94	\$22.72	\$23.53	\$24.40
Range	38	\$18.42	\$19.09	\$20.06	\$20.79	\$21.52	\$22.29	\$23.11	\$23.95	\$24.80
Range	39	\$18.79	\$19.47	\$20.46	\$21.20	\$21.95	\$22.73	\$23.54	\$24.41	\$25.28
Range	40	\$19.09	\$19.76	\$20.79	\$21.52	\$22.29	\$23.11	\$23.95	\$24.80	\$25.71
Range	41	\$19.48	\$20.17	\$21.21	\$21.97	\$22.75	\$23.56	\$24.43	\$25.31	\$26.24
Range	42	\$19.80	\$20.51	\$21.57	\$22.33	\$23.16	\$23.98	\$24.85	\$25.77	\$26.71
Range	43	\$20.14	\$20.86	\$21.94	\$22.72	\$23.53	\$24.40	\$25.27	\$26.20	\$27.17
Range	44	\$20.51	\$21.27	\$22.33	\$23.16	\$23.98	\$24.85	\$25.77	\$26.71	\$27.70
Range	45	\$20.87	\$21.62	\$22.73	\$23.54	\$24.41	\$25.28	\$26.21	\$27.18	\$28.19
Range	46	\$21.28	\$22.04	\$23.17	\$24.00	\$24.87	\$25.80	\$26.73	\$27.71	\$28.75
Range	47	\$21.65	\$22.44	\$23.57	\$24.44	\$25.34	\$26.28	\$27.23	\$28.25	\$29.28
Range	48	\$22.02	\$22.82	\$23.98	\$24.85	\$25.77	\$26.71	\$27.70	\$28.73	\$29.79
Range	49	\$22.44	\$23.27	\$24.44	\$25.34	\$26.28	\$27.23	\$28.25	\$29.28	\$30.37
Range	50	\$22.84	\$23.69	\$24.87	\$25.80	\$26.73	\$27.71	\$28.75	\$29.81	\$30.93
Range	51	\$23.30	\$24.16	\$25.37	\$26.31	\$27.27	\$28.29	\$29.32	\$30.41	\$31.55
Range	52	\$23.70	\$24.56	\$25.81	\$26.74	\$27.73	\$28.76	\$29.83	\$30.94	\$32.09
Range	53	\$24.16	\$25.04	\$26.31	\$27.27	\$28.29	\$29.32	\$30.41	\$31.55	\$32.76
Range	54	\$24.60	\$25.50	\$26.79	\$27.77	\$28.79	\$29.85	\$30.97	\$32.12	\$33.33
Range	55	\$25.07	\$26.00	\$27.30	\$28.32	\$29.35	\$30.46	\$31.58	\$32.76	\$33.98
Range	56	\$25.49	\$26.42	\$27.76	\$28.78	\$29.84	\$30.96	\$32.11	\$33.32	\$34.55

Effective: July 1, 2024

2024 - 2025 Hourly Non-Bargaining Pay Scale

Employees only receive their step increase on their anniversary

Employees at the top of their plan will receive 3.5% and will become a "Standard Rate" in the payroll system

		Step 1	Step 2	Step 3	Step 4	Step 5	Step 6	Step 7	Step 8	Step 9
Range	57	\$25.98	\$26.92	\$28.29	\$29.32	\$30.41	\$31.55	\$32.73	\$33.94	\$35.20
Range	58	\$26.44	\$27.41	\$28.79	\$29.85	\$30.97	\$32.12	\$33.33	\$34.57	\$35.90
Range	59	\$26.94	\$27.95	\$29.34	\$30.44	\$31.56	\$32.74	\$33.96	\$35.22	\$36.56
Range	60	\$27.44	\$28.47	\$29.88	\$31.00	\$32.17	\$33.38	\$34.63	\$35.93	\$37.28
Range	61	\$27.93	\$28.97	\$30.41	\$31.55	\$32.73	\$33.94	\$35.20	\$36.54	\$37.92
Range	62	\$28.47	\$29.54	\$31.00	\$32.17	\$33.38	\$34.63	\$35.93	\$37.28	\$38.68
Range	63	\$28.93	\$30.11	\$31.50	\$32.79	\$34.01	\$35.28	\$36.60	\$37.97	\$39.41
Range	64	\$29.56	\$30.67	\$32.20	\$33.40	\$34.66	\$35.95	\$37.31	\$38.71	\$40.17
Range	65	\$30.10	\$31.22	\$32.78	\$33.99	\$35.26	\$36.59	\$37.96	\$39.39	\$40.89
Range	66	\$30.67	\$31.82	\$33.40	\$34.66	\$35.95	\$37.31	\$38.71	\$40.17	\$41.72
Range	67	\$31.24	\$32.41	\$34.02	\$35.29	\$36.63	\$38.02	\$39.43	\$40.92	\$42.50
Range	68	\$31.84	\$33.03	\$34.67	\$35.97	\$37.33	\$38.73	\$40.19	\$41.73	\$43.31
Range	69	\$32.43	\$33.65	\$35.32	\$36.65	\$38.03	\$39.45	\$40.95	\$42.51	\$44.12
Range	70	\$33.03	\$34.27	\$35.97	\$37.33	\$38.73	\$40.19	\$41.73	\$43.31	\$44.96
Range	71	\$33.65	\$34.92	\$36.65	\$38.03	\$39.45	\$40.95	\$42.51	\$44.12	\$45.79
Range	72	\$34.27	\$35.56	\$37.33	\$38.73	\$40.19	\$41.73	\$43.31	\$44.96	\$46.67
Range	73	\$34.94	\$36.25	\$38.05	\$39.48	\$40.97	\$42.53	\$44.15	\$45.85	\$47.60
Range	74	\$35.62	\$36.96	\$38.79	\$40.24	\$41.78	\$43.36	\$45.02	\$46.73	\$48.53
Range	75	\$35.59	\$36.96	\$38.76	\$40.24	\$41.81	\$43.43	\$45.12	\$46.88	\$48.69
Range	76	\$36.25	\$37.66	\$39.48	\$41.01	\$42.59	\$44.25	\$45.96	\$47.75	\$49.61
Range	77	\$36.96	\$38.39	\$40.24	\$41.81	\$43.43	\$45.12	\$46.88	\$48.69	\$50.59
Range	78	\$37.67	\$39.12	\$41.03	\$42.60	\$44.27	\$45.98	\$47.76	\$49.62	\$51.55
Range	79	\$38.40	\$39.89	\$41.82	\$43.44	\$45.14	\$46.89	\$48.71	\$50.61	\$52.57
Range	80	\$39.15	\$40.68	\$42.63	\$44.30	\$46.01	\$47.81	\$49.66	\$51.60	\$53.60
Range	81	\$39.89	\$41.45	\$43.44	\$45.14	\$46.89	\$48.71	\$50.61	\$52.57	\$54.60

**Jasper County Salary Pay Plan for 2024-2025
Salaried Employees (Non Dept. Heads)**

Effective July 1, 2024

Employees in progression will only receive their step increase on their anniversary

Employees at the top of their plan will receive 3.5% and will become a "Standard Rate" in the payroll system

	Step 1	Step 2	Step 3	Step 4	Step 5	Step 6	Step 7	Step 8	Step 9
Range 6 SP	\$37,825	\$38,808	\$39,822	\$41,193	\$42,262	\$43,367	\$44,503	\$45,674	\$46,880
Range 7 SP	\$39,823	\$40,867	\$41,927	\$43,368	\$44,504	\$45,660	\$46,880	\$48,121	\$49,399
Range 8 SP	\$41,943	\$43,049	\$44,189	\$45,676	\$46,882	\$48,123	\$49,402	\$50,720	\$52,078
Range 9 SP	\$44,188	\$45,362	\$46,572	\$48,121	\$49,399	\$50,718	\$52,075	\$53,472	\$54,911
Range 10 SP	\$46,570	\$47,819	\$49,101	\$50,716	\$52,075	\$53,472	\$54,911	\$56,395	\$57,922
Range 11 SP	\$49,103	\$50,424	\$51,786	\$53,475	\$54,913	\$56,396	\$57,926	\$59,498	\$61,119
Range 12 SP	\$51,785	\$53,187	\$54,632	\$56,395	\$57,922	\$59,496	\$61,116	\$62,785	\$64,502
Range 13 SP	\$54,629	\$56,116	\$57,650	\$59,493	\$61,112	\$62,782	\$64,501	\$66,270	\$68,094
Range 14 SP	\$57,652	\$59,230	\$60,857	\$62,785	\$64,502	\$66,274	\$68,098	\$69,976	\$71,913
Range 15 SP	\$60,858	\$62,532	\$64,257	\$66,275	\$68,098	\$69,977	\$71,913	\$73,904	\$75,956
Range 16 SP	\$64,256	\$66,032	\$67,861	\$69,976	\$71,909	\$73,902	\$75,955	\$78,070	\$80,247
Range 17 SP	\$67,860	\$69,747	\$71,689	\$73,901	\$75,955	\$78,070	\$80,245	\$82,489	\$84,798
Range 18 SP	\$71,690	\$73,688	\$75,749	\$78,071	\$80,247	\$82,492	\$84,802	\$87,182	\$89,633
Range 19 SP	\$75,749	\$77,871	\$80,057	\$82,492	\$84,802	\$87,183	\$89,633	\$92,157	\$94,757
Range 20 SP	\$80,054	\$82,304	\$84,623	\$87,181	\$89,630	\$92,156	\$94,754	\$97,433	\$100,190
Range 21 SP	\$84,624	\$87,011	\$89,470	\$92,157	\$94,757	\$97,434	\$100,192	\$103,033	\$105,961
Range 22 SP	\$89,470	\$92,003	\$94,611	\$97,434	\$100,192	\$103,033	\$105,961	\$108,975	\$112,081
Range 23 SP	\$94,609	\$97,297	\$100,066	\$103,032	\$105,959	\$108,974	\$112,080	\$115,276	\$118,572
Range 24 SP	\$100,068	\$102,920	\$106,463	\$108,975	\$112,081	\$115,940	\$118,573	\$121,966	\$125,459
Range 25 SP	\$105,855	\$108,881	\$111,995	\$115,277	\$118,573	\$121,965	\$125,459	\$129,056	\$132,765
Range 26 SP	\$111,993	\$115,202	\$118,506	\$121,963	\$125,456	\$129,055	\$132,762	\$136,580	\$140,514
Range 27 SP	\$118,508	\$121,913	\$125,421	\$129,058	\$132,765	\$136,585	\$140,518	\$144,569	\$148,739
Range 28 SP	\$125,417	\$129,031	\$132,748	\$136,581	\$140,517	\$144,565	\$148,738	\$153,035	\$157,463

Approved by the Board of Supervisors on

Revised Policy

Hourly Non-Bargaining, Salaried Non-Department Head, and Department Head Employees wage Policy:

1. Newly Hired Hourly Non-Bargaining Employees:

All new Hourly Non-Bargaining employees hired will start at an agreed upon range and step of the current pay plan. Hourly non-bargaining employees will only receive their annual step increase on their anniversary date until they reach the top of the pay plan. At which time, they will be moved to a "Standard" hourly rate in the payroll system and will be eligible to receive the Annual Cost of Living (ACOL) increase on July 1 as approved by the Jasper County Board of Supervisors.

2. Current Hourly Non-Bargaining Employees:

Effective July 1, 2024, all current hourly non-bargaining employees will no longer be eligible for both the annual progressive step increase and the annual cost of living (ACOL) increase on July 1. As of July 1, 2024, all current hourly non-bargaining employees still on a progressive step pay plan will only receive their annual step increase on their anniversary date until they reach the top of the pay plan. At which time, they will be moved to a "Standard" hourly rate in the payroll system and will be eligible to receive the Annual Cost of Living (ACOL) increase on July 1 as approved by the Jasper County Board of Supervisors.

3. Newly Hired Non-Department Head Salaried Employees:

All new Non-Department Head salaried employees hired will start at an agreed upon range and step of the current pay plan. Non-Department Head salaried employees will only receive their annual step increase on their anniversary date until they reach the top of the pay plan. At which time, they will be moved to a "Standard" salary in the payroll system and will be eligible to receive the Annual Cost of Living (ACOL) increase on July 1 as approved by the Jasper County Board of Supervisors.

4. Current Non-Department Head Salaried Employees:

Effective July 1, 2024, all current salaried employees will no longer be eligible for both the annual progressive step increase and the annual cost of living (ACOL) increase on July 1. As of July 1, 2024, all current salaried employees still on a progressive step pay plan will only receive their annual step increase on their anniversary date until they reach the top of the pay plan. At which time, they will be moved to a "Standard" salary in the payroll system and will be eligible to receive the Annual Cost of Living (ACOL) increase on July 1 as approved by the Jasper County Board of Supervisors.

5. Newly Hired Department Head Employees:

Effective immediately upon approval by the Jasper County Board of Supervisors, all new Department Head employees hired will start at an agreed upon salary and will be subject to an annual review by the Jasper County Board of Supervisors. Based on the annual review, they will be adjusted appropriately as determined by the Jasper County Board of Supervisors for July 1.

6. Current Department Head Employees (at the top of the progressive step pay plan):

Effective immediately, all current Department Head employees who are at the top of their progressive step pay plan will be subject to an annual review by the Jasper County Board of Supervisors. Based on the annual review, Department Head salaries will be adjusted appropriately as determined by the Jasper County Board of Supervisors.

7. Current Department Head Employees (still in a progressive step pay plan):

The Jasper County Board of Supervisors will establish a new "Standard" salary for current Department Head Employees still in a progressive step pay plan. Once the salary is established, current Department Head Employees will no longer be on a progressive pay plan and will be subject to an annual review by the Jasper County Board of Supervisors. Based on the annual review, Department Head salaries will be adjusted appropriately as determined by the Jasper County Board of Supervisors.

Main Office
1351 Iowa Speedway Dr.
Newton, IA 50208
Ph: 800-400-6066
Fax: 641-792-6982



Branch Office
205 C Avenue
Grundy Center, IA 50638
Ph: 319-824-5920
Fax: 319-824-6045

www.irua.net

We Flow That Extra Mile!

February 22, 2024

Jasper County Conservation
Attn: Ethan VanderPol
1030 W 2nd St S
Newton IA 50208

Re: Mariposa Rural Water Easement

Dear Ethan,

I was sending the work order over to our construction department so we can get started running the bigger main over to the park and realized that I forgot to have the County sign an easement for the portion of the line that will be located within the park. Please have this signed and return to our office. I went ahead and sent the work order to construction, so this won't delay the project any further. I know you have already been more than patient with our busy workload.

Should you have questions concerning this matter, please contact me at 641-792-7011 or trozendaal@irua.net.

Sincerely,

Todd Rozendaal
IOWA REGIONAL UTILITIES ASSOCIATION

Prepared by: Gayla E. Hannagan of Iowa Regional Utilities Association, 1351 Iowa Speedway Drive, Newton, Iowa, 50208 (Telephone: 641-792-7011)

WHEN RECORDED RETURN TO: Iowa Regional Utilities Association, R-O-W Department, 1351 Iowa Speedway Drive, Newton, Iowa 50208

LIMITED EASEMENT

No: 102-81-18-32-8

RE:

The Southwest Quarter (SW $\frac{1}{4}$) of the Southeast Quarter (SE $\frac{1}{4}$) of Section Thirty-two (32), Township Eighty-one (81) North, Range Eighteen (18) West of the 5th P.M., in Jasper County, Iowa; subject to easements and public roads of record.

Owners of Record: Jasper County, Iowa

The undersigned record owner(s) of equitable interests in the real estate shown above or attached, for good and valuable consideration, hereby convey(s) to Iowa Regional Utilities Association, ("Association"), its successors and assigns, a perpetual easement in, to, and running with such real estate, together with a general perpetual right of ingress and egress upon such real estate and any adjacent lands of owner(s) for meter reading, pipeline maintenance, or other reasonable Association purposes. By this instrument, the Association may construct, lay, own, use, operate, inspect, maintain, repair, replace or remove waterlines and any necessary appurtenances thereto upon, under and through such real estate. Once the waterlines and appurtenances are completely installed and operating, then this easement (except the general rights of ingress and egress) shall reduce in scope to a width of 30 feet, the centerline of which will be the waterlines and appurtenances. During initial construction, no crop damage will be paid by the Association, unless otherwise agreed upon in writing. The Association will try to place the pipe lines within about ten to twenty feet from fences adjacent to road rights of way except to avoid natural or man-made obstructions or to comply with governmental requirements or upon verbal requests of any owner or agent of any owner prior to initial construction. The Association will fix any damage it causes to fences or tile lines. The Association will pay for crop damages it may cause due to repairs or maintenance of its property after one year from the date of initial construction. Owner(s) promise to immediately inform each (if any) tenant relative to this easement and will protect the Association from any claims of a tenant. If an owner's spouse is not presently a record owner, then the spouse signs this easement only for the purpose of relinquishing the legal spousal interests. Each owner signing below represents that he, she or it has an equitable interest of record in the real estate and authority to grant these easement interests. This instrument shall be deemed dated and in full force and effect as of the first date shown on the acknowledgment(s) below. If there's any technical deficiency in this instrument or the way it was signed, then this document shall nonetheless be a perpetual easement as to all interests in the real estate held by the undersigned and a perpetual license running with the land given by the undersigned on behalf of all owners of record and occupants to the Association, its successors or assigns, for such purposes.

Jasper County, Iowa

(By): _____

(By): _____

ALL PURPOSE ACKNOWLEDGMENT

STATE OF IOWA)
(ss.
COUNTY OF _____)

On this _____ day of _____, A.D. 20____, before me, the
Undersigned, a Notary Public in and for said State, personally
appeared _____
_____ to me personally known
or
_____ proved to me on the basis of satisfactory evidence

to be the person(s) whose name(s) is/are subscribed to the
within instrument and acknowledged to me that he/she/they
executed the same as his/her/their authorized capacity(ies),
and that by his/her/their signature(s) on the instrument the
person(s), or the entity upon behalf of which the person(s)
acted, executed the instrument.

_____(Sign in Ink)
_____(Print/type Name)

Notary Public in and for the County of _____
And State of Iowa

CAPACITY CLAIMED BY SIGNER

_____ INDIVIDUAL
_____ CORPORATE
_____ Title(s) of Corporate Officer(s):

_____ Corporate Seal is affixed
_____ No Corporate Seal procured

_____ PARTNERS(s):
_____ Limited Partnership
_____ General Partnership
_____ ATTORNEY-IN-FACT
_____ EXECUTOR(s) or TRUSTEE(s)
_____ GUARDIAN(s) or CONSERVATOR(s)
_____ OTHER

SIGNER IS REPRESENTING:
List name(s) of person(s) or entity(ies):

Resolution
Expressing Support for Improvements to the Water Distribution System in
Sully, Iowa and Support for a Community Project Funding Application

WHEREAS, the Jasper County Supervisors are supportive of high-quality municipal services to all Jasper County residents; and

WHEREAS, Sully, a city in Jasper County, has identified a need for improved water quality and increased fire protection; and

WHEREAS, the City of Sully has engaged in a process to prepare plans, cost estimates, a financial plan for Water Distribution System Improvements; and

WHEREAS, the City of Sully has determined that additional funding, beyond the City's current resources, will be required to complete the project

NOW, THEREFORE, BE IT HEREBY RESOLVED by the Jasper County Board of Supervisors that Jasper County expresses support for the proposed Water Distribution System Improvements in Sully, Iowa and support an application for Community Project Funding.

Brandon Talsma, Board Chairperson

Attest: Jenna Jennings, County Auditor

Date

Date

RESOLUTION _____

WHEREAS, the Jasper County Board of Supervisors met during FY24/25 budget hearings and made the following recommendations for the following Salaried Department Heads for the Fiscal Year 24/25 beginning July 1, 2024.

THEREFORE, BE IT RESOLVED THAT the Jasper County Board of Supervisors approve the following salary adjustments for the following Salaried Department Heads for the Fiscal Year 24/25 beginning July 1, 2024.

<u>Department Head</u>	<u>Department</u>	<u>Approved Salary</u>
Alyssa Wilson	Veteran Affairs	\$ 66,377.00
Adam Sparks	Maintenance	\$106,389.00
Becky Pryor	Board of Health	\$107,300.00
Connie McQuiston	General Assistance	\$78,000.00
Dennis Simon	Human Resources	\$105,289.00
Jason Doland	Information Technology	\$87,372.00
Kelli Van Manen	Congregate Meals	\$74,177.00
Keri Van Zante	Conservation	\$100,000.00
Kevin Luetters	Community Development	\$100,436.00
Ryan Eaton	Information Technology	\$129,418.00

Approved this 5th day of March 2024.

JASPER COUNTY BOARD OF SUPERVISORS

ATTEST:

Brandon Talsma, Chairperson

Jenna Jennings, Auditor

March 5, 2024

Tuesday, March 5, 2024, the Jasper County Board of Supervisors met in regular session at 9:30 a.m. with Supervisors Talsma, Cupples, and Stevenson present and accounted for; Chairman Talsma presiding.

Motion by Cupples, seconded by Stevenson to approve a law enforcement contract between the City of Baxter, and the Jasper County Sheriff's Office to provide temporary law enforcement services in the amount of \$3,000.00 per month through June 30, 2024.

YEA: CUPPLES, TALSMAS, STEVENSON

Motion by Cupples, seconded by Stevenson to adopt Resolution 24-24, a hiring resolution certifying the following appointment to the Auditor for payroll implementation.

<u>DEPARTMENT</u>	<u>POSITION</u>	<u>EMPLOYEE</u>	<u>PAY RATE</u>	<u>RANGE/STEP</u>	<u>EFFECTIVE DATE</u>
Emergency Management	Deputy Director	Steven Ashing	\$65,827	Annual Salary	4/1/2024

YEA: STEVENSON, TALSMAS, CUPPLES

A complete copy of the resolution is on file in the Office of the Jasper County Auditor.

Motion by Cupples, seconded by Stevenson to approve the Board of Supervisors minutes from February 27, 2024.

YEA: CUPPLES, TALSMAS, STEVENSON

No Board Appointments

Motion by Cupples, seconded by Stevenson to enter into Closed Session requested by Scott Nicholson in accordance with Iowa Code Section 21.5(c) to discuss strategy with counsel in matters that are presently in litigation or where litigation is imminent where its disclosure would be likely to prejudice or disadvantage the position of the governmental body in that litigation.

YEA: CUPPLES, TALSMAS, STEVENSON

Motion by Stevenson, seconded by Cupples to come out of close session.

YEA: CUPPLES, TALSMAS, STEVENSON

Motion by Stevenson, seconded by Cupples authorizing County Attorney Scott Nicholson and Dennis Simon to work with outside legal counsel to send a demand letter as discussed in the closed session.

YEA: CUPPLES, TALSMAS, STEVENSON

Motion by Stevenson, seconded by Cupples to enter into Closed Session requested by Scott Nicholson in accordance with Iowa Code Section 21.5(c) to discuss strategy with counsel in matters that are presently in litigation or where litigation is imminent where its disclosure would be likely to prejudice or disadvantage the position of the governmental body in that litigation.

YEA: CUPPLES, TALSMAS, STEVENSON

Motion by Cupples, seconded by Stevenson to come out of close session.

YEA: CUPPLES, TALSMAS, STEVENSON

Motion by Cupples, seconded by Stevenson authorizing the Board Chairman to sign an agreement with Solar Pile Driver to remove and reinstall solar panels with the money approved from the insurance company upon approval of a letter being sent to Simpleray releasing us from our contract.

YEA: CUPPLES, TALSMAS, STEVENSON

Motion by Stevenson, seconded by Cupples to adjourn the Tuesday, March 5, 2024, meeting of the Jasper County Board of Supervisors.

YEA: CUPPLES, TALSMAS, STEVENSON

Jenna Jennings, Auditor

Brandon Talsma, Chairman

SECONDARY ROADS FIVE YEAR PROGRAM

Iowa Department of Transportation
SECONDARY ROADS FIVE YEAR PROGRAM

County: Jasper County
Fiscal Year: 2025
Version: Original

COUNTY CERTIFICATION	
The detailed construction program for the secondary road system was adopted by the Board of Supervisors on _____	_____
	Date
ATTESTED	
_____ County Auditor	_____
	Date
_____ County Engineer	_____
	Date
_____ Chairperson, Board of Supervisors	_____
	Date
IOWA DOT PROGRAM APPROVALS	
Recommended Approval: _____	_____
OLS Reviewer	Date
Approval: _____	_____
Director of Local Systems	Date

Generated on 3/7/2024 10:02 AM

SECONDARY ROADS FIVE YEAR PROGRAM

						Accomp Year	Priority Years				Total
Project Number Project Name Project ID	Location Description of Work Section / Township / Range	AADT Length Federal ID	Status FM Transfer	Day Labor Type of Work Project Type	Fund		FY 2025	FY 2026	FY 2027	FY 2028	
FM-C050(138)--55-50 HMA Resurfacing - Quicksilver Ave 52710	On Quicksilver, from 1500' E of IA 163 SE 1.3 miles to Monroe CL 23 / 78 / 20	49 1.300 miles	Previous	\$0 366 HMA Paving FM	Local						\$950
					FM	950					
					Special						
					FA						
					SWAP						
FM-C050(139)--55-50 HMA Resurfacing - Poplar Ave 52709	On Poplar Ave, from 1487' E of W 116th St E 0.7 miles to Prairie City CL 3 / 78 / 21	200 0.700 miles 601985	Previous	\$0 366 HMA Paving FM	Local						\$500
					FM	500					
					Special						
					FA						
					SWAP						
FM-C050(140)--55-50 Pavement Improvements - E 125th St N 37407	On E 125TH ST N, from US Hwy 6 N 1.6 miles to N 39th Ave E 21 / 80 / 17	122 1.600 miles	Previous	\$0 365 Stabilized Base FM	Local						\$1,000
					FM	1,000					
					Special						
					FA						
					SWAP						
FM-C050()-55-50 Pavement Maintenance - F-70 W 55065	On F 70, from Monroe CL W 5.9 miles to.S 6 G 34 / 78 / 20	530 5.900 miles	New	\$0 399 Other FM	Local						\$300
					FM	300					
					Special						
					FA						
					SWAP						

SECONDARY ROADS FIVE YEAR PROGRAM

						Accomp Year	Priority Years				Total
Project Number Project Name Project ID	Location Description of Work Section / Township / Range	AADT Length Federal ID	Status FM Transfer	Day Labor Type of Work Project Type	Fund		FY 2025	FY 2026	FY 2027	FY 2028	
FM-C050()-55-50 Pavement Maintenance - F-34 W 55066	On F 34, from Polk County Line E 1.3 miles to Beginning of PCC 17 / 80 / 21	450 1.300 miles	New	\$0 399 Other FM	Local						\$65
					FM	65					
					Special						
					FA						
					SWAP						
BRS-C050(132)--60-50 Bridge Replacement - T06 51166	On F 62, Over NORTH SKUNK RIVER, from E 160th St S W 0.6 miles S12 T78 R17 12 / 78 / 17	1068 0.000 miles 30840	Previous	\$0 320 Bridges FA	Local						\$3,500
					FM						
					Special						
					FA	2,800					
					SWAP	700					
BROS-5110(602)--8J-50 Bridge Replacement - F04 49766	In the city of Mingo, On N E ST, Over SMALL NATURAL STREAM, from E Main St N 0.2 miles S3 T80 R21 City Bridge Funds awarded for this project. Maximum reimbursable limit is set at \$1,500,000. 3 / 80 / 21	344 0.000 miles 198462	Previous	\$0 320 Bridges FA	Local						\$1,500
					FM						
					Special						
					FA	1,500					
					SWAP						
BRS-C050()-60-50 Bridge Replacement - A11 55075	On F 17, Over ROCK CREEK, from E 124th St N W 0.1 miles S17 T81 R17 17 / 81 / 17	530 0.000 miles 198770	New	\$0 320 Bridges FA	Local						\$2,000
					FM						
					Special						
					FA	1,600					
					SWAP	400					

SECONDARY ROADS FIVE YEAR PROGRAM

Project Number Project Name Project ID	Location Description of Work Section / Township / Range	AADT Length Federal ID	Status FM Transfer	Day Labor Type of Work Project Type	Fund	Accomp	Priority Years				Total	
						Year	1st	2nd	3rd	4th		
						FY 2025	FY 2026	FY 2027	FY 2028	FY 2029		
L--73-63 Local Bridge Replacement - S33 53247	On COUNTY LINE RD, Over BRANCH SKUNK RIVER, from E 88th St S W 0.2 miles S3 T77 R18 3 / 77 / 18	74 0.000 miles 240840	Previous	\$30 320 Bridges Local	Local	60						\$60
					FM							
					Special							
					FA							
					SWAP							
L-C050()-73-50 HMA Resurfacing - E 142nd St S 52882	On E 142nd St S, from S 12th Ave E S 0.4 miles to End of Road 2 / 79 / 17	11 0.400 miles	Previous	\$0 366 HMA Paving Local	Local	300						\$300
					FM							
					Special							
					FA							
					SWAP							
L-C050(N17)--73-50 Local Bridge Replacement 49786	On S 52ND AVE W, Over SMALL STREAM, from W 68th St S E 0.7 miles S23 T79 R20 23 / 79 / 20	10 0.000 miles 197210	Previous	\$60 320 Bridges Local	Local	120						\$120
					FM							
					Special							
					FA							
					SWAP							
L-C050(C05)--73-50 Local Bridge Replacement 49784	On N 115TH AVE W, Over SNIPE CREEK, from E 12th St N W 1.1 miles S4 T81 R19 4 / 81 / 19	49 0.000 miles 199050	Previous	\$30 320 Bridges Local	Local	125						\$125
					FM							
					Special							
					FA							
					SWAP							

SECONDARY ROADS FIVE YEAR PROGRAM

Project Number Project Name Project ID	Location Description of Work Section / Township / Range	AADT Length Federal ID	Status FM Transfer	Day Labor Type of Work Project Type	Fund	Accomp	Priority Years				Total	
						Year	1st	2nd	3rd	4th		
						FY 2025	FY 2026	FY 2027	FY 2028	FY 2029		
L-C050(K15)-73-50 Local Bridge Replacement 49842	On S 36TH AVE E, Over SUGAR CREEK, from HWY T- 38 S E 0.8 miles S12 T79 R17 12 / 79 / 17	20 0.000 miles 196331	Previous	\$60 320 Bridges Local	Local	250						\$250
					FM							
					Special							
					FA							
					SWAP							
FLAP-C050(133)-6L-50 Pavement Improvements - W 129th St S and S 96th Ave W 52885	W 129TH ST S from IA 163 S 2.4 miles to S 96th Ave W and S 96th Ave W from W 129th St S E 2 miles to Pacific St 17 / 78 / 21	26 4.400 miles	Previous	\$0 364 Bituminous Seal Coat FA	Local						\$0	
					FM							
					Special							
					FA							
					SWAP							
STP-S-C050(144)-5E-50 HMA Resurfacing - F-48 W from IA 117 N to Bridge N03 38755	On F-48 W, Over IAIS RR, from IA 117 N E 2.8 miles to Bridge N03 (NBIS 30401) 4 / 79 / 20	10 2.800 miles	Previous	\$0 366 HMA Paving FA	Local						\$2,100	
					FM	1,600						
					Special							
					FA	500						
					SWAP							
FM-C050()-55-50 Pavement Maintenance - S-74 S 55081	On S 74, from Newton CL S 7.2 miles to Reasnor CL 26 / 79 / 19	11 7.200 miles	New	\$0 364 Bituminous Seal Coat FM	Local						\$400	
					FM		400					
					Special							
					FA							
					SWAP							

SECONDARY ROADS FIVE YEAR PROGRAM

Project Number Project Name Project ID	Location Description of Work Section / Township / Range	AADT Length Federal ID	Status FM Transfer	Day Labor Type of Work Project Type	Fund	Accomp	Priority Years				Total
						Year	1st	2nd	3rd	4th	
						FY 2025	FY 2026	FY 2027	FY 2028	FY 2029	
BRS-C050()-60-50 Bridge Replacement - S07 55007	On F 62, Over ELK CREEK, from Shawnee Ave E 0.2 miles S10 T78 R18 10 / 78 / 18	1370 0.000 miles 195300	New	\$0 320 Bridges FA	Local						\$1,600
					FM						
					Special						
					FA		1,280				
					SWAP		320				
BRS-C050()-60-50 Bridge Replacement - O10 32218	On County Road F48, Over Small Stream, from W 124th St S NE 0.1 miles S10 T79 R21 10 / 79 / 21	1250 0.010 miles 30370	Previous	\$0 320 Bridges FA	Local						\$1,100
					FM						
					Special						
					FA		880				
					SWAP		220				
L-C050(R01)--73-50 Local Bridge Replacement 49770	On E 40TH ST S, Over REASNOR CREEK, from S 76th Ave E S 0.1 miles S1 T78 R19 1 / 78 / 19	39 0.000 miles 195581	Previous	\$100 320 Bridges Local	Local		200				\$200
					FM						
					Special						
					FA						
					SWAP						
LFM-C050(D05)--7X-50 Local Bridge Replacement 49765	On N 107TH AVE W, Over CLEAR CREEK, from W 100th ST N E 1.2 miles S5 T81 R20 5 / 81 / 20	48 0.000 miles 199310	Previous	\$120 320 Bridges Local	Local		470				\$470
					FM						
					Special						
					FA						
					SWAP						

SECONDARY ROADS FIVE YEAR PROGRAM

						Accomp Year	Priority Years				Total
Project Number	Location	AADT	Status	Day Labor			1st	2nd	3rd	4th	
Project Name	Description of Work	Length	FM	Type of Work	Fund	FY	FY	FY	FY	FY	
Project ID	Section / Township / Range	Federal ID	Transfer	Project Type		2025	2026	2027	2028	2029	
L-C050(R20)--73-50 Local Bridge Replacement 50970	On W 24TH ST S, Over BUCK CREEK, from S 112th Ave W S 0.3 miles S30 T78 R19 30 / 78 / 19	99 0.000 miles 195740	Previous	\$70 320 Bridges Local	Local		150				\$150
					FM						
					Special						
					FA						
					SWAP						
LFM-C050(C16)--7X-50 Local Bridge Replacement 55076	On N 99th Ave E, Over LITTLE SNIPE CREEK, from E 20th St N W S14 T81 R19 14 / 81 / 19	30 0.000 miles 199150	New	\$60 320 Bridges Local	Local		250				\$250
					FM						
					Special						
					FA						
					SWAP						
LFM---7X-50 Pavement Replacement - T-22 S 55079	On T 22, from S 44th Ave E N 0.2 miles to 0.4 miles N of S44th Ave E 12 / 79 / 18	1790 0.200 miles	New	\$0 367 PCC Paving Local	Local		150				\$150
					FM						
					Special						
					FA						
					SWAP						
FLAP-C050()-6L-50 Pavement Improvements - W 129th St S 52890	On W 129TH ST S, from S 96th Ave W S 1.0 miles to S 102nd Ave W 17 / 78 / 21	16 1.000 miles	Previous	\$0 364 Bituminous Seal Coat FA	Local						\$0
					FM						
					Special						
					FA						
					SWAP						

SECONDARY ROADS FIVE YEAR PROGRAM

Project Number Project Name Project ID	Location Description of Work Section / Township / Range	AADT Length Federal ID	Status FM Transfer	Day Labor Type of Work Project Type	Fund	Accomp	Priority Years				Total
						Year	1st	2nd	3rd	4th	
						FY 2025	FY 2026	FY 2027	FY 2028	FY 2029	
FLAP-C050()-7L-50 Pavement Improvements - S 102nd Ave W 52891	On S 102ND AVE W, from W 129th St S E .5 miles to End of Road 17 / 78 / 21	16 0.500 miles	Previous	\$0 364 Bituminous Seal Coat FA	Local						\$0
					FM						
					Special						
					FA						
					SWAP						
STP-S-C050()-5E-50 HMA Resurfacing - T-38 N from 180 N to US 6 E 52711	On T-38 N, from I 80 W N 1.7 miles to US 6 E 26 / 80 / 17	10 1.700 miles 31260	Previous	\$0 366 HMA Paving FA	Local						\$1,200
					FM		700				
					Special						
					FA		500				
					SWAP						
L-C050(B07)-73-50 Local Bridge Replacement 49841	On N 99TH AVE E, Over ALLOWAY CREEK, from E 84th St N W 0.3 miles S16 T81 R18 16 / 81 / 18	10 0.000 miles 198921	Previous	\$60 320 Bridges Local	Local			130			\$130
					FM						
					Special						
					FA						
					SWAP						
LFM-C050(C19)-7X-50 Local Bridge Replacement 55078	On N 99TH AVE E, Over SNIPE CREEK, from W 4th St N E 0.5 miles S10 T81 R19 10 / 81 / 19	90 0.000 miles 199170	New	\$70 320 Bridges Local	Local			320			\$320
					FM						
					Special						
					FA						
					SWAP						

SECONDARY ROADS FIVE YEAR PROGRAM

						Accomp Year	Priority Years				Total
Project Number Project Name Project ID	Location Description of Work Section / Township / Range	AADT Length Federal ID	Status FM Transfer	Day Labor Type of Work Project Type	Fund		FY 2025	FY 2026	FY 2027	FY 2028	
L-C050(L12)--73-50 Local Bridge Replacement 50971	On E 84TH ST S, Over PRAIRIE CREEK, from S 44th Ave E S 0.3 miles S16 T79 R18 16 / 79 / 18	69 0.000 miles 196630	Previous	\$100 320 Bridges Local	Local			250			\$250
					FM						
					Special						
					FA						
					SWAP						
L-C050(N22)--73-50 Local Bridge Replacement 50974	On F 58, Over SQUAW CREEK, from W 92nd St S W 0.5 miles S30 T79 R20 30 / 79 / 20	99 0.000 miles 197240	Previous	\$70 320 Bridges Local	Local			150			\$150
					FM						
					Special						
					FA						
					SWAP						
L-C050(L01)--73-50 Local Bridge Replacement 50975	On S 12TH AVE E, Over SMALL STREAM, from E 60th St S E 0.3 miles S5 T79 R18 5 / 79 / 18	99 0.000 miles 196530	Previous	\$70 320 Bridges Local	Local			150			\$150
					FM						
					Special						
					FA						
					SWAP						
FLAP-C050(--7L-50 Bridge Replacement - P01 49840	On S 88TH AVE W, Over WALNUT CREEK, from W 117th St S W 0.2 miles S9 T78 R21 9 / 78 / 21	24 0.000 miles 195950	Previous	\$0 320 Bridges FA	Local						\$0
					FM						
					Special						
					FA						
					SWAP						

SECONDARY ROADS FIVE YEAR PROGRAM

						Accomp Year	Priority Years				Total
Project Number Project Name Project ID	Location Description of Work Section / Township / Range	AADT Length Federal ID	Status FM Transfer	Day Labor Type of Work Project Type	Fund		FY 2025	FY 2026	FY 2027	FY 2028	
STP-S-C050()-5E-50 HMA Resurfacing - F-48 W from Polk Co to Colfax CL 44674	On F48 W from Polk County E 5.3 miles to West CL of Colfax	1470 5.300 miles 30370	Previous	\$0 366 HMA Paving FA	Local						\$4,000
					FM			3,500			
					Special						
					FA			500			
	11 / 79 / 21				SWAP						
FM-C050()-55-50 PCC Unbonded Overlay - F-27 E from E136th St N to T-38 N 52898	On F 27, from E 136th St N E 1.5 miles to T 38	31 1.500 miles	Previous	\$0 367, PCC Paving FM	Local						\$1,500
					FM				1,500		
					Special						
					FA						
	10 / 80 / 17				SWAP						
L-C050(T04)--73-50 Local Bridge Replacement 50976	On E 132ND ST S, Over SMALL STREAM, from Temple Ave S 0.6 miles S4 T78 R17	87 0.000 miles 195010	Previous	\$70 320 Bridges Local	Local				150		\$150
					FM						
					Special						
					FA						
	4 / 78 / 17				SWAP						
L-C050(B02)--73-50 Local Bridge Replacement 45874	On E 84TH ST N, Over SMALL STREAM, from N 107th Ave W N 0.4 miles S4 T81 R18	5 0.000 miles 198861	Previous	\$60 320 Bridges Local	Local				130		\$130
					FM						
					Special						
					FA						
	4 / 81 / 18				SWAP						

SECONDARY ROADS FIVE YEAR PROGRAM

						Accomp Year	Priority Years				Total
Project Number Project Name Project ID	Location Description of Work Section / Township / Range	AADT Length Federal ID	Status FM Transfer	Day Labor Type of Work Project Type	Fund		FY 2025	FY 2026	FY 2027	FY 2028	
L-C050(E16)--73-50 Local Bridge Replacement 49782	On N 95TH AVE W, Over SILVER CREEK, from W 140th St N W 0.6 miles S18 T81 R21 18 / 81 / 21	34 0.000 miles 199620	Previous	\$50 320 Bridges Local	Local				100		\$100
					FM						
					Special						
					FA						
					SWAP						
STP-S-C050()-5E-50 HMA Resurfacing F-62 W 55080	On F 62, from IA 14 S E 3.5 miles to Reasnor CL 10 / 78 / 19	810 3.500 miles	New	\$0 366 HMA Paving FA	Local						\$2,500
					FM			2,000			
					Special						
					FA			500			
					SWAP						
FM-C050()-55-50 Pavement Improvements - Republic Ave 37404	On Republic Ave, from Monroe CL E 4.8 miles to E 40th St S 31 / 78 / 19	120 4.800 miles	Previous	\$0 364 Bituminous Seal Coat FM	Local						\$2,000
					FM				2,000		
					Special						
					FA						
					SWAP						
BROS-C050()-8J-50 Bridge Replacement - I07 49768	On F 27, Over NORTH SKUNK RIVER, from N 55th Ave E S 0.1 miles S8 T80 R18 8 / 80 / 18	99 0.000 miles 197730	Previous	\$0 320 Bridges FA	Local						\$2,000
					FM						
					Special						
					FA				2,000		
					SWAP						

SECONDARY ROADS FIVE YEAR PROGRAM

						Accomp Year	Priority Years				Total
Project Number Project Name Project ID	Location Description of Work Section / Township / Range	AADT Length Federal ID	Status FM Transfer	Day Labor Type of Work Project Type	Fund		FY 2025	FY 2026	FY 2027	FY 2028	
L-C050(L25)-73-50 Local Bridge Replacement 49769	On S 60TH AVE E, Over ELK CREEK, from E 84th St S W 0.2 miles S28 T79 R18 28 / 79 / 18	39 0.000 miles 196741	Previous	\$60 320 Bridges Local	Local					250	\$250
					FM						
					Special						
					FA						
					SWAP						
L-C050(I18)-73-50 Local Bridge Replacement 49785	On INDIGO AVE, Over COON CREEK, from Kellog E 0.1 miles S24 T80 R18 24 / 80 / 18	87 0.000 miles 197840	Previous	\$100 320 Bridges Local	Local					200	\$200
					FM						
					Special						
					FA						
					SWAP						

SECONDARY ROADS FIVE YEAR PROGRAM

Fund	2025	2026	2027	2028	2029
SWAP	\$1,100,000	\$540,000	\$0	\$0	\$0
FM	\$4,415,000	\$1,100,000	\$3,500,000	\$3,500,000	\$2,000,000
Local	\$855,000	\$1,220,000	\$1,000,000	\$380,000	\$450,000
FA	\$6,400,001	\$2,660,002	\$500,001	\$500,000	\$2,000,000